

# CALIPER disc brakes



## Stop. Hold. Maintain Tension.

From as little as 600 to over 50,000 inch pounds of braking torque, W.C. Branham Inc. makes a wide range of caliper disc brakes for industrial and off-highway vehicular applications. Choose from pneumatic, hydraulic, mechanical, hydraulic or pneumatic spring applied, and dual function mechanical/hydraulic models.

Each of our caliper disc brakes is made of either quality machined or cast aluminum construction and hardcoated for long service life. Friction pad linings are made from non-asbestos material and are field replaceable. Standard models sized for disc thicknesses of 5/32 inch (spacer option A), 1/4 inch (B), 3/8 inch (L) and 1/2 inch (E). Custom spacers can be made for other disc thicknesses.

## industrial uses

Manipulator arms | Hose reels | Web and wire tensioning | Packaging | Printing presses | CNC machinery | Conveyor belts | Wind energy | Indexers

### 38 SERIES

Pneumatic floating/fixed P38S, P38D | Hydraulic floating/fixed H38S, H38D | Mechanical M38

- Unlimited disc diameter
- Dynamic torque (inch/lb) 70 lbf per 100 psi x braking radius, HP38
- Dynamic torque (inch/lb) 2.69 x lever force (lb.) x braking radius, M38
- Parking/static torque (inch/lb) 35 lbf per 100 psi x braking radius, HP38
- Parking/static torque (inch/lb) 1.75 x lever force (lb.) x braking radius, M38
- 2.0 in.2 total friction pad area
- 1000 psi maximum HP38
- Buna N seals standard, EPR seals for automotive brake fluid (G)
- Internal crossover porting for double acting fixed models
- Optional floating bracket
- Search: **P38S, H38S, P38D, H38D, M38**



P38SF

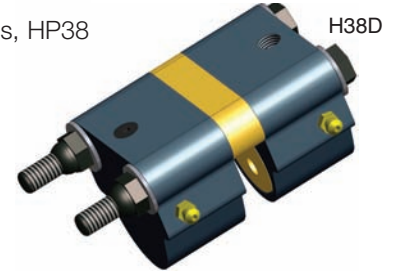

H38D

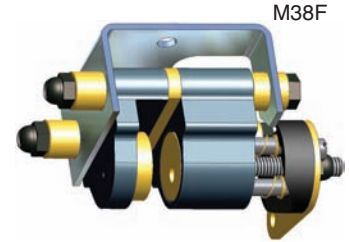

M38F

### 47 SERIES

Pneumatic floating/fixed P47SF, P47D | Hydraulic floating/fixed H47S, H47D | Mechanical M47

- Unlimited disc diameter
- Dynamic torque (inch/lb) 144 lbf per 100 psi x braking radius, HP47
- Dynamic torque (inch/lb) 2.69 x lever force (lb.) x braking radius, M47
- Parking/static torque (inch/lb) 72 lbf per 100 psi x braking radius, HP47
- Parking/static torque (inch/lb) 1.75 x lever force (lb.) x braking radius, M47
- 4.0 in.2 total friction pad area
- 1000 psi maximum HP47
- Retractable piston option (R)
- Buna N seals standard, EPR seals for automotive brake fluid (G)
- Internal crossover porting double acting fixed models
- Optional floating bracket.
- Search: **P47S, H47S, P47D, H47D, M47**

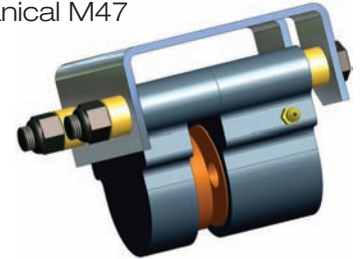

H47SF



H47D

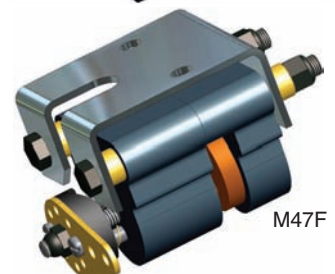

M47F

# CALIPER disc brakes

## 200 SERIES

Pneumatic floating/fixed P200S P200D

Hydraulic floating/fixed H200S, H200D | Mechanical M200

- Up to 16 inch disc diameter
- Dynamic torque (inch/lb)  $288 \text{ lbf per } 100 \text{ psi} \times \text{braking radius}$ , HP200
- Dynamic torque (inch/lb)  $7.45 \times \text{lever force (lb.)} \times \text{braking radius}$ , M200
- Parking/static torque (inch/lb)  $144 \text{ lbf per } 100 \text{ psi} \times \text{braking radius}$ , HP200
- Parking/static torque (inch/lb)  $3.73 \times \text{lever force (lb.)} \times \text{braking radius}$ , M200
- 8.0 in.2 total friction pad area
- 1500 psi maximum HP200
- Retractable piston option (R)
- Buna N Seals Standard, EPR Seals for automotive brake fluid (G)
- Internal crossover porting double acting fixed models
- Optional floating bracket
- Search: [P200S](#), [H200S](#), [P200D](#), [H200D](#), [M200](#)

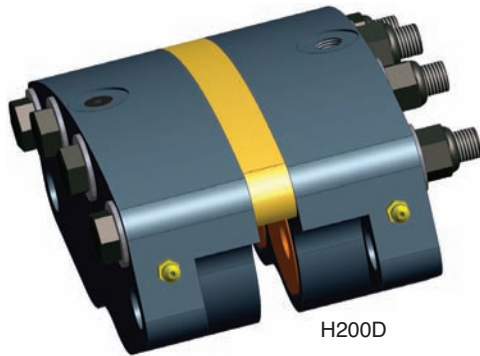

H200D

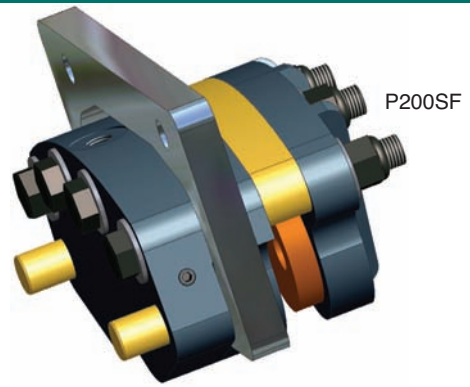

P200SF

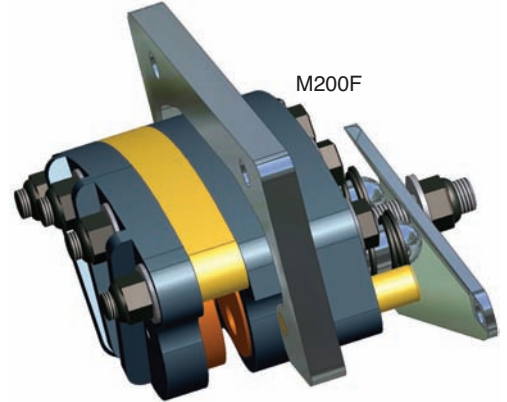

M200F

## 47/200 SERIES

Dual Function Mechanical/Hydraulic

- Up to 16 inch disc diameter
- Dynamic torque (inch/lb)  $144 \text{ lbf per } 100 \text{ psi} \times \text{braking radius}$ , MH47
- Dynamic torque (inch/lb)  $288 \text{ lbf per } 100 \text{ psi} \times \text{braking radius}$ , MH200
- Lever forces to 450 lb MH47, 580 lb MH200
- 8.0 in.2 total friction pad area
- 1000 psi maximum
- 1.625 inch friction pad diameter
- Spring retractable pistons
- Buna N seals standard, EPR seals for automotive brake fluid (G)
- Optional floating bracket
- Search: [MH47S](#), [MH200](#)



MH200

## 962 SERIES

Pneumatic/Hydraulic fixed P962D, H962D

- 12 to 18 inch disc diameter
- Change brake pads without dismounting brake
- Dynamic torque (inch/lb)  $693 \text{ lbf per } 100 \text{ psi} \times \text{braking radius}$
- Static torque (inch/lb)  $347 \text{ lbf per } 100 \text{ psi} \times \text{braking radius}$
- Internal crossover porting double acting
- Buna N Seals Standard, EPR Seals for automotive brake fluid (G)
- 21.96 in.2 total friction pad area
- 9.62 in.2 piston area
- 1000 psi maximum
- 3.5 inch piston diameter
- Search: [P962](#), [H962](#)

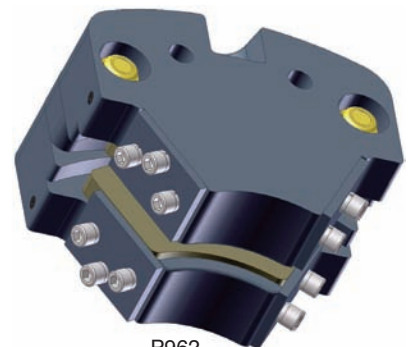

P962

## vehicular off-highway uses

| Utility trucks | Road construction | Turf vehicles | Lift trucks | Aircraft ground support equipment | Military trailers | Agricultural tractors | Mining

Enter search terms at [www.wcbranham.com](http://www.wcbranham.com) for more information

# CALIPER disc brakes

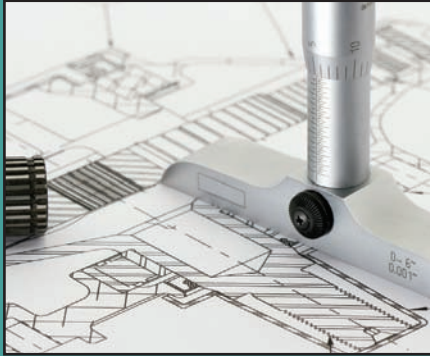

## Emergency Stopping. Pneumatic. Hydraulic.

*Spring applied caliper disc brakes function opposite of all other W.C. Branham Inc. pneumatic and hydraulic brakes. Normal brake operation requires active pressure to perform braking function and pressure removed to release.*

*Pneumatic PFS and Hydraulic FS models require active minimum pressure to release from braking. When pressure loss is experienced, the energy stored in the loaded Belleville disc spring stacks provides positive braking to stop the load.*

*These brakes are ideal for emergency stopping and holding of industrial machinery and off-highway vehicles.*

## standard features

Our caliper disc brakes are made of either quality precision machined or cast aluminum construction and hardcoated for long service life.

## 47/200 SERIES

Failsafe Spring Applied Pneumatic PFS47, PFS200  
Hydraulic FS47, FS200

- Unlimited disc diameter 47 series.
- Up to 16 inch disc diameter 200 series
- 85 PSI release pressure PFS47/200
- 750 PSI release pressure FS47/200
- 465 lb. tangential force 47 series\*
- 930 lb. tangential force 200 series\*
- 4.0 in.2 total friction pad area 200 series
- 8.0 in.2 total friction pad area 200 series
- 1000 psi maximum 47 series
- 1500 psi maximum 200 series
- Buna N Seals Standard, EPR Seals for automotive brake fluid (G)
- Optional floating bracket
- Search: **PFS47, PFS200, FS47, FS200**

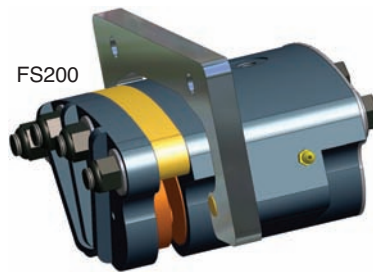
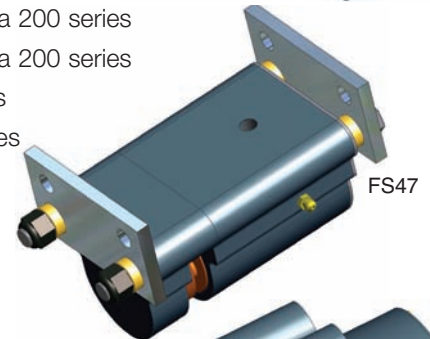
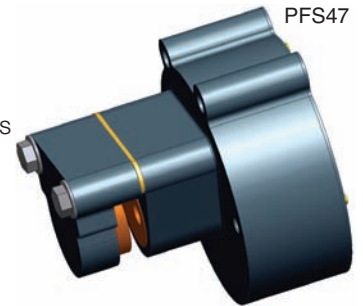

*\*As pad wear effects brake torque, spring applied brakes should not be used for tensioning or high cyclic stopping applications.*

## DISCS AND DISC & HUB ASSEMBLIES

- 5 disc diameters available, 6 5/16", 8", 10", 12", 16"
- Use with 38, 47, 200 series caliper disc brakes
- Machined discs with bolt circle and pilot hole
- Blank discs also available
- Wide selection of hubs for each disc diameter
- 1008/1010 carbon steel
- Stress relieved
- Flat to .010 inch
- Blanchard ground
- 80 RMS finish
- Search: **4801 (6 5/16"), 4802 (8"), 4803 (10"), 4804 (12"), 4805 (16")**

