

MODEL NO.	BORE SIZE	KEY SIZE
4803-0014	.875	1/4 X 1/4
4803-0016	1.00	1/4 X 1/4
4803-0018	1.125	1/4 X 1/4
4803-0020	1.250	1/4 X 1/4
4803-0022	1.375	5/16 X 5/16
4803-0024	1.500	3/8 X 3/8
4803-0026	1.625	3/8 X 3/8
4803-0028	1.750	3/8 X 3/8

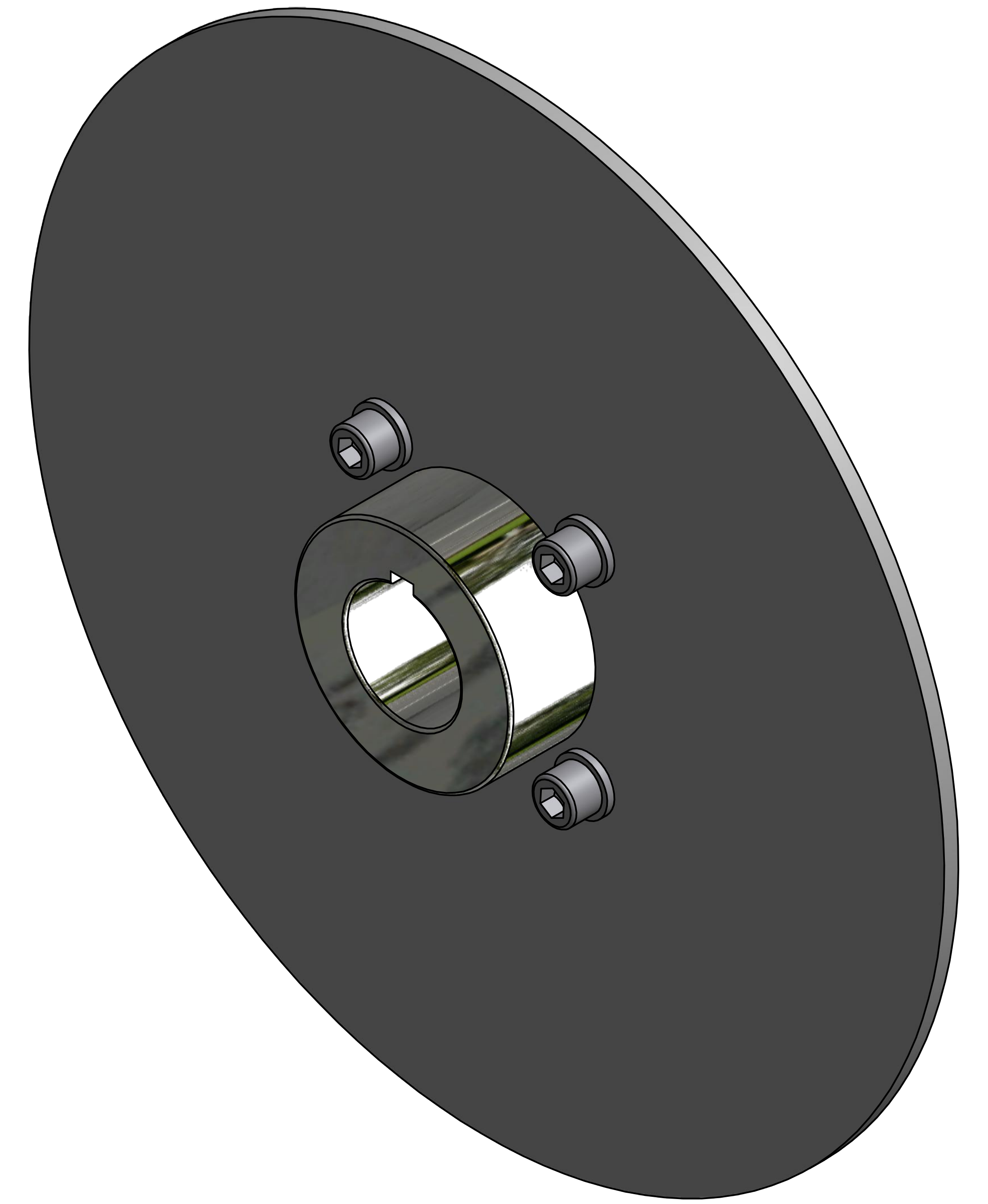
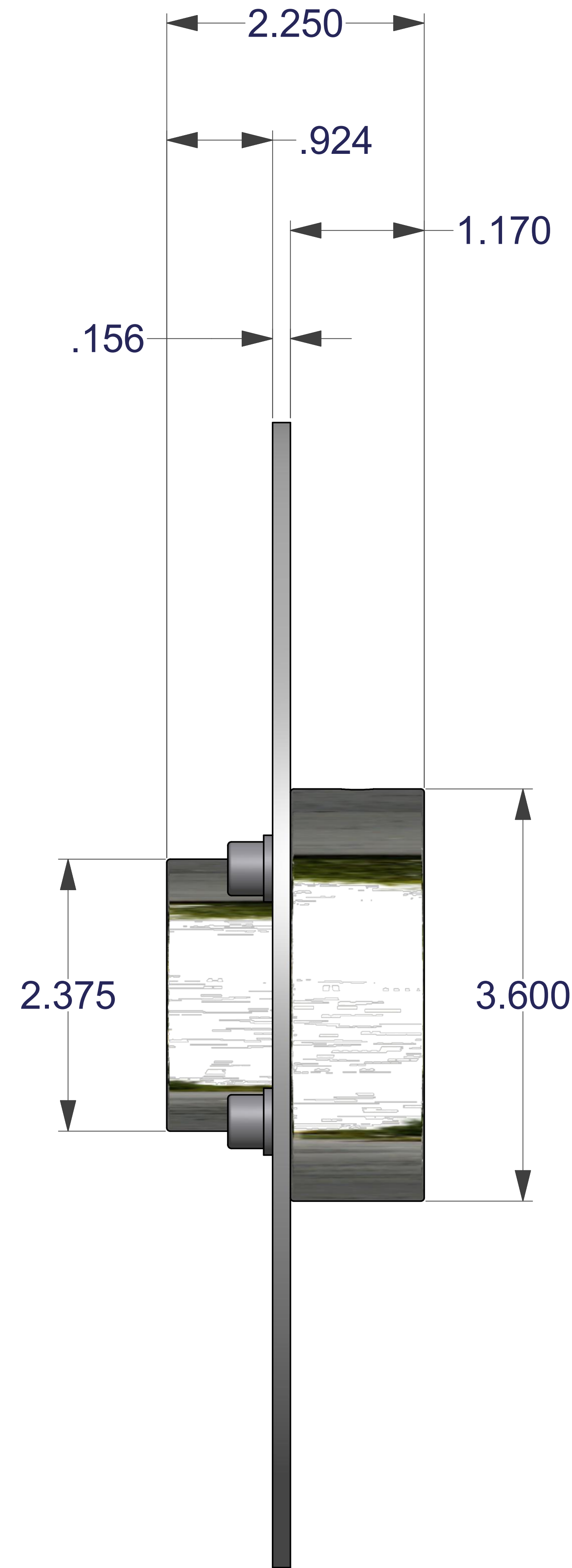
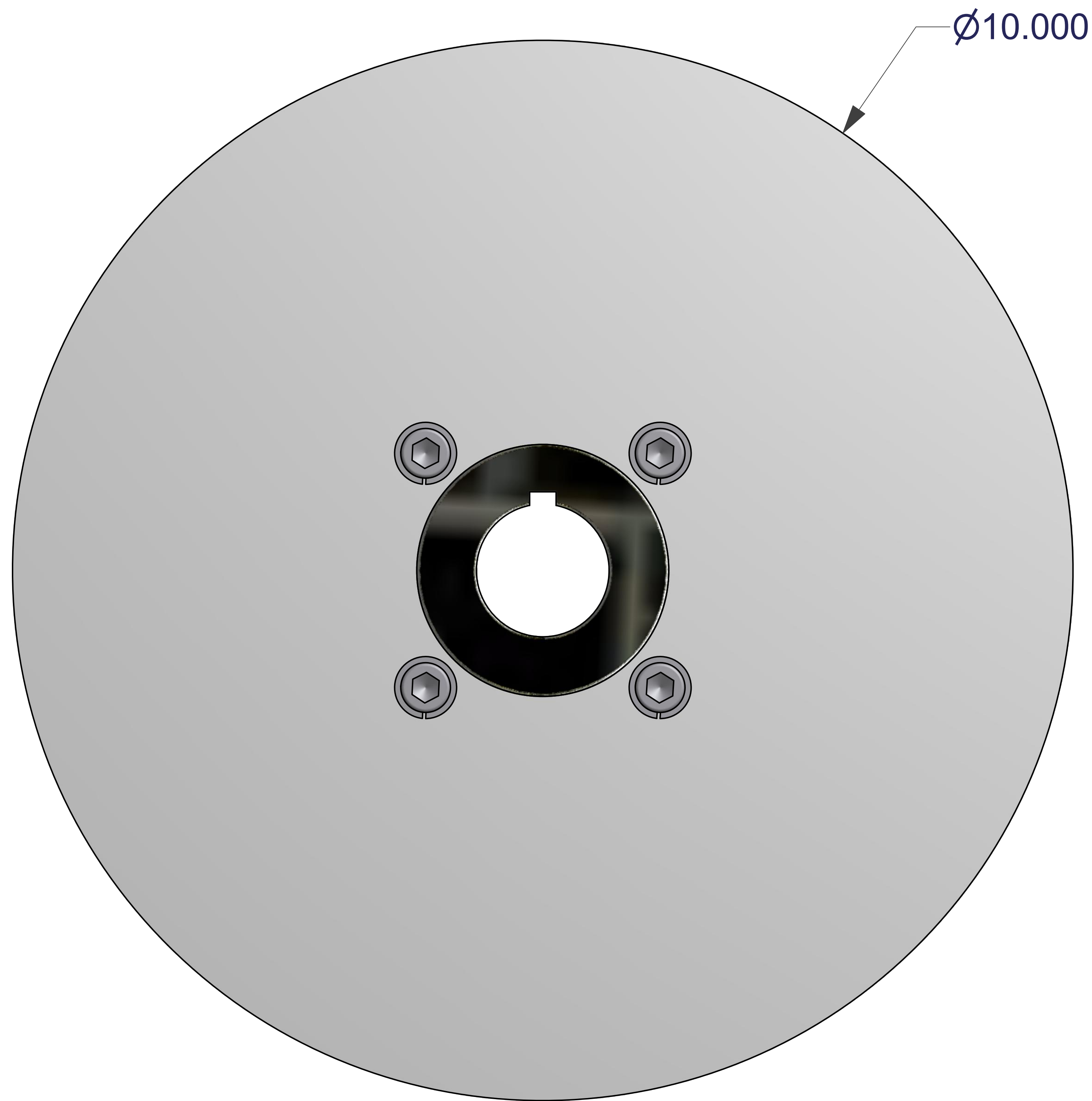

- \* MATERIAL: 1010/1015 STEEL STRESS RELIEVED
- \* SURFACES PARALLEL WITHIN .010
- \* SURFACES GROUND TO 80 RMS
- \* HUBS MACHINED FROM 1018 STEEL
- \* TEMPERATURE RATED TO 300 DEGREES
- \* FOR USE WITH 38, 47, 200, 400 SERIES CALIPERS

UNLESS OTHERWISE SPECIFIED: DO NOT SCALE DRAWING REMOVE ALL BURRS TAP DEPTHS FULL THD. DRILL DEPTHS FULL DIA.		THIRD ANGLE PROJECTION		W.C. BRANHAM INC. RIVER FALLS, WI.	
TOLERANCES 2 PLACE +/- .010 3 PLACE +/- .005		DESIGNER WCB	DATE 08/17/11	TITLE 10 IN. HUB/DISC ASSEMBLIES	
THREADS EXTERNAL CLASS 2A INTERNAL CLASS 2B		CHECKER	DATE	DRAWING NO. 4803-0020	REVISION
SCALE		CLASS		SIZE <b>E</b>	