

MODEL NO.	BORE SIZE	KEY SIZE
4801-0008	.500	1/8 X 1/8
4801-0010	.625	3/16 X 3/16
4801-0012	.750	3/16 X 3/16
4801-0014	.875	3/16 X 3/16
4801-0016	1.00	1/4 X 1/4

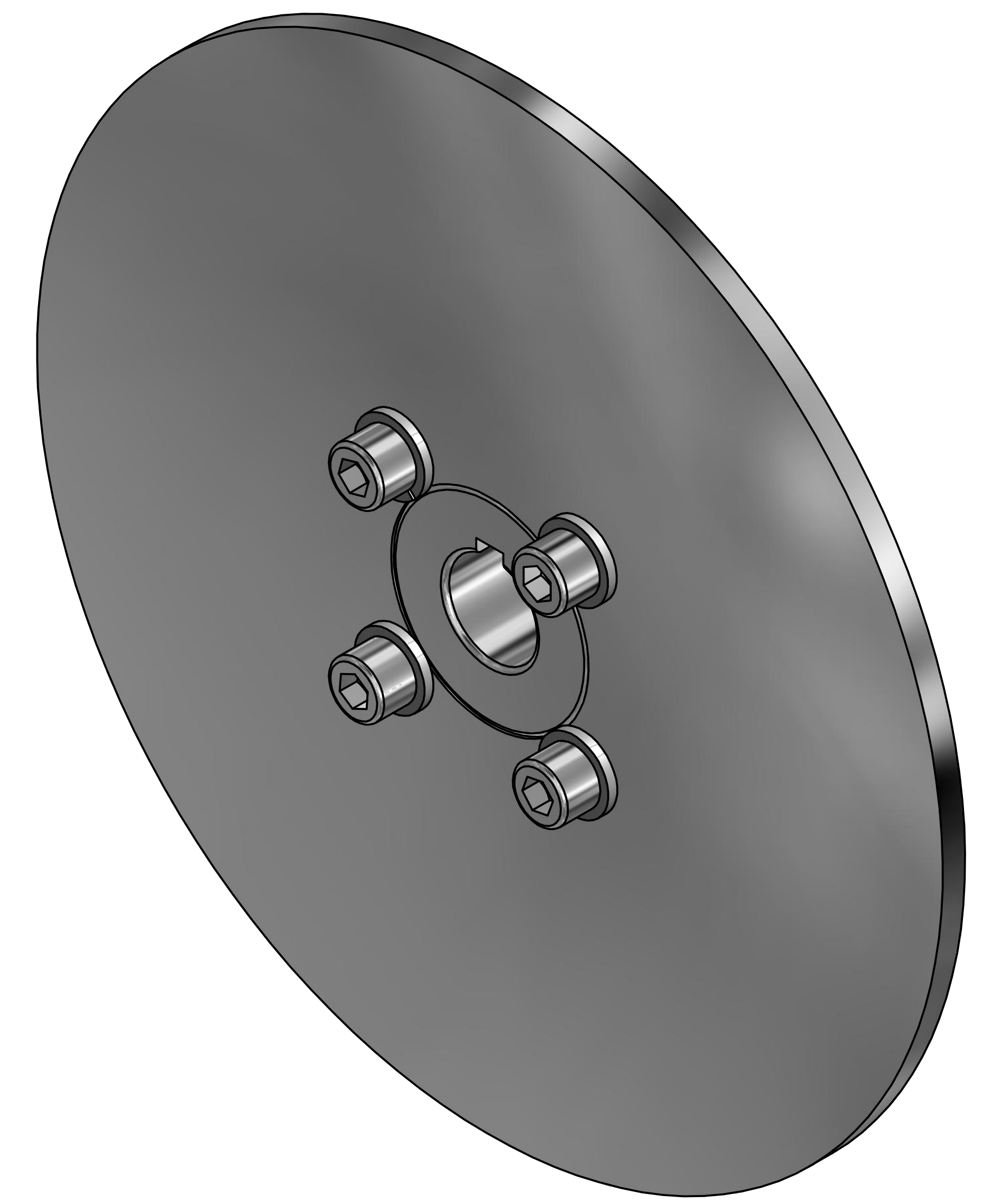
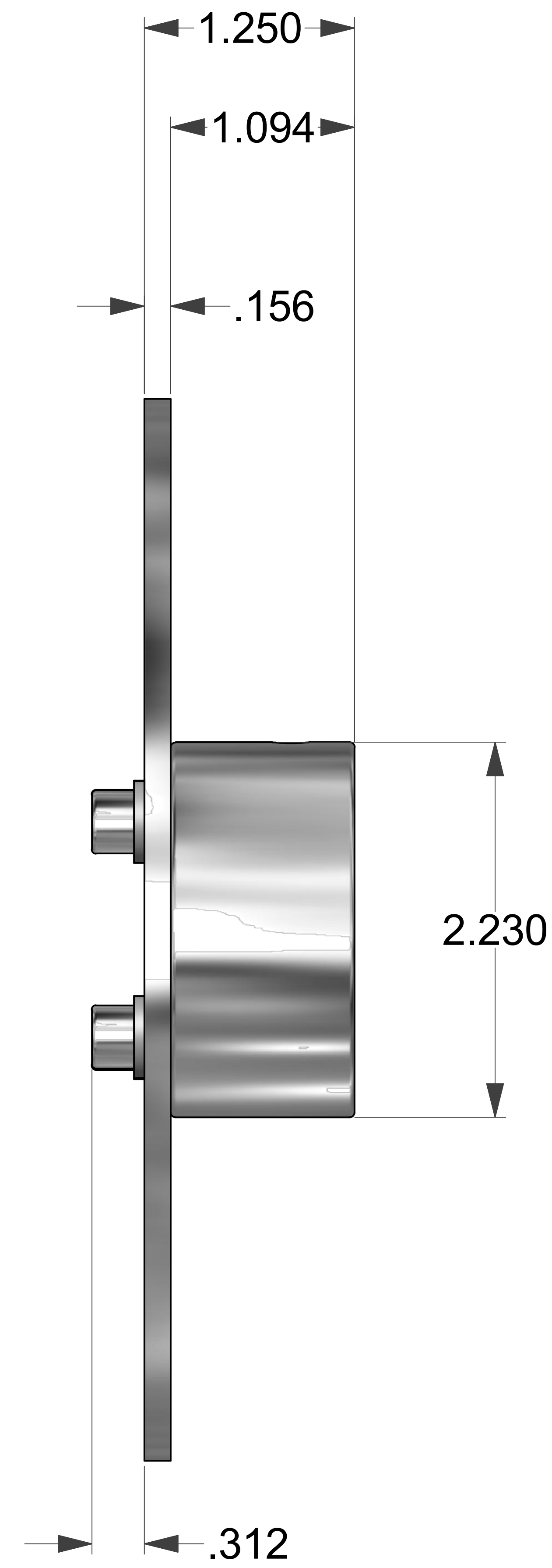
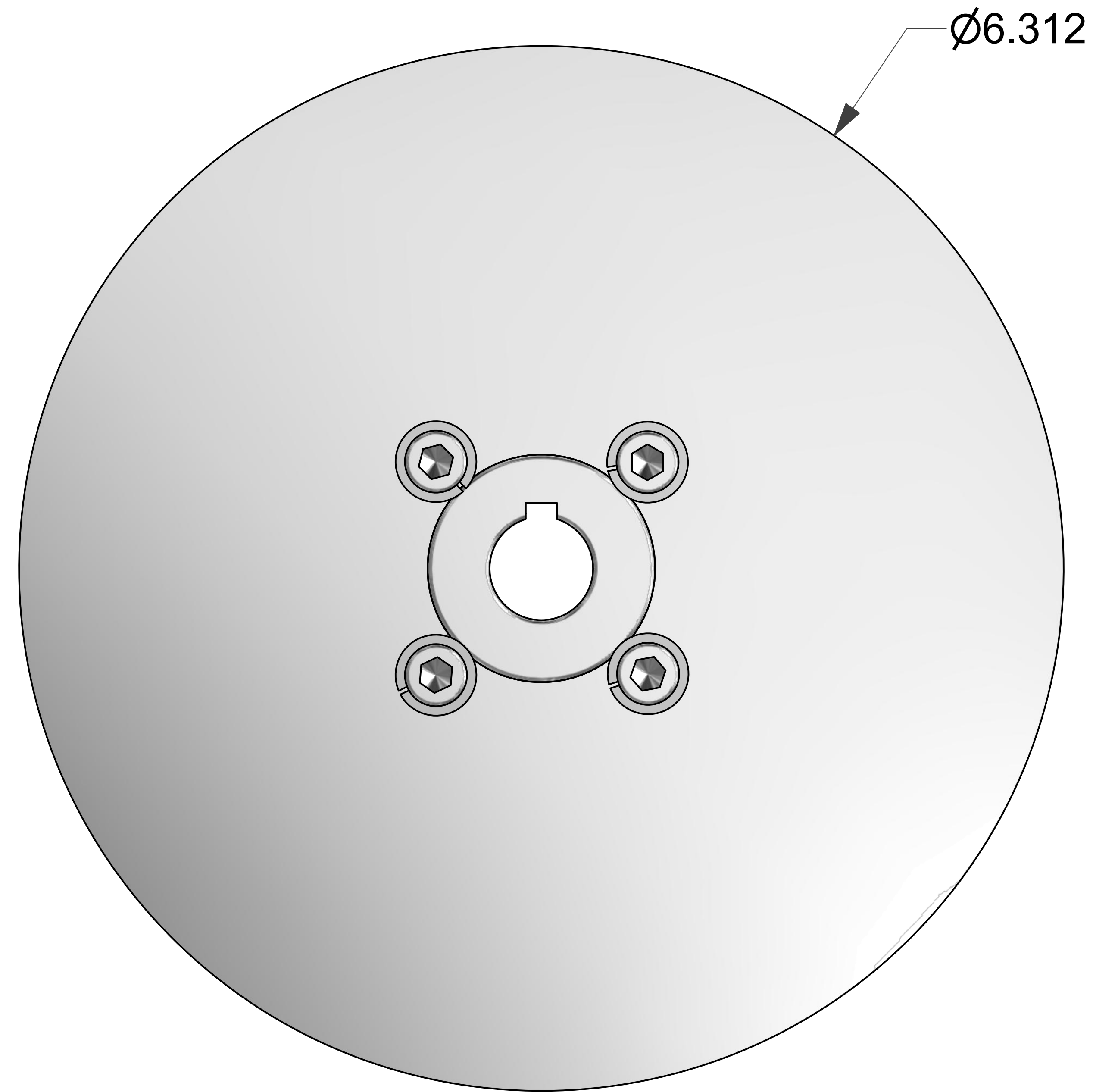

- \* MATERIAL: 1010/1015 STEEL STRESS RELIEVED
- \* SURFACES PARALLEL WITHIN .010
- \* SURFACES GROUND TO 80 RMS
- \* HUBS MACHINED FROM 1018 STEEL
- \* TEMPERATURE RATED TO 300 DEGREES
- \* FOR USE WITH 38, 47, 200 & 400 SERIES CALIPERS

UNLESS OTHERWISE SPECIFIED: DO NOT SCALE DRAWING REMOVE ALL BURRS TAP DEPTHS FULL THD. DRILL DEPTHS FULL DIA.		THIRD ANGLE PROJECTION		W.C. BRANHAM INC. RIVER FALLS, WI.	
TOLERANCES 2 PLACE +/- .010 3 PLACE +/- .005		DESIGNER WCB	DATE 08-17-11	TITLE 6 IN. HUB/DISC ASSEMBLIES	
THREADS EXTERNAL CLASS 2A INTERNAL CLASS 2B		CHECKER	DATE	DRAWING NO. 4801-0008	REVISION
SCALE		CLASS		SIZE E	