

INPUT TORQUE = OUTPUT TORQUE / .6, IN. LBS.

RPM OUTPUT TORQUE, IN. LBS.

33	358
50	312
100	248
200	198
300	172
400	122
500	111
1,000	90
1,200	85

MAX. HAND TORQUE - 609 IN. LBS.

KEY SIZES

30mm	-- 8mm
25mm	-- 8mm
20mm	-- 6mm

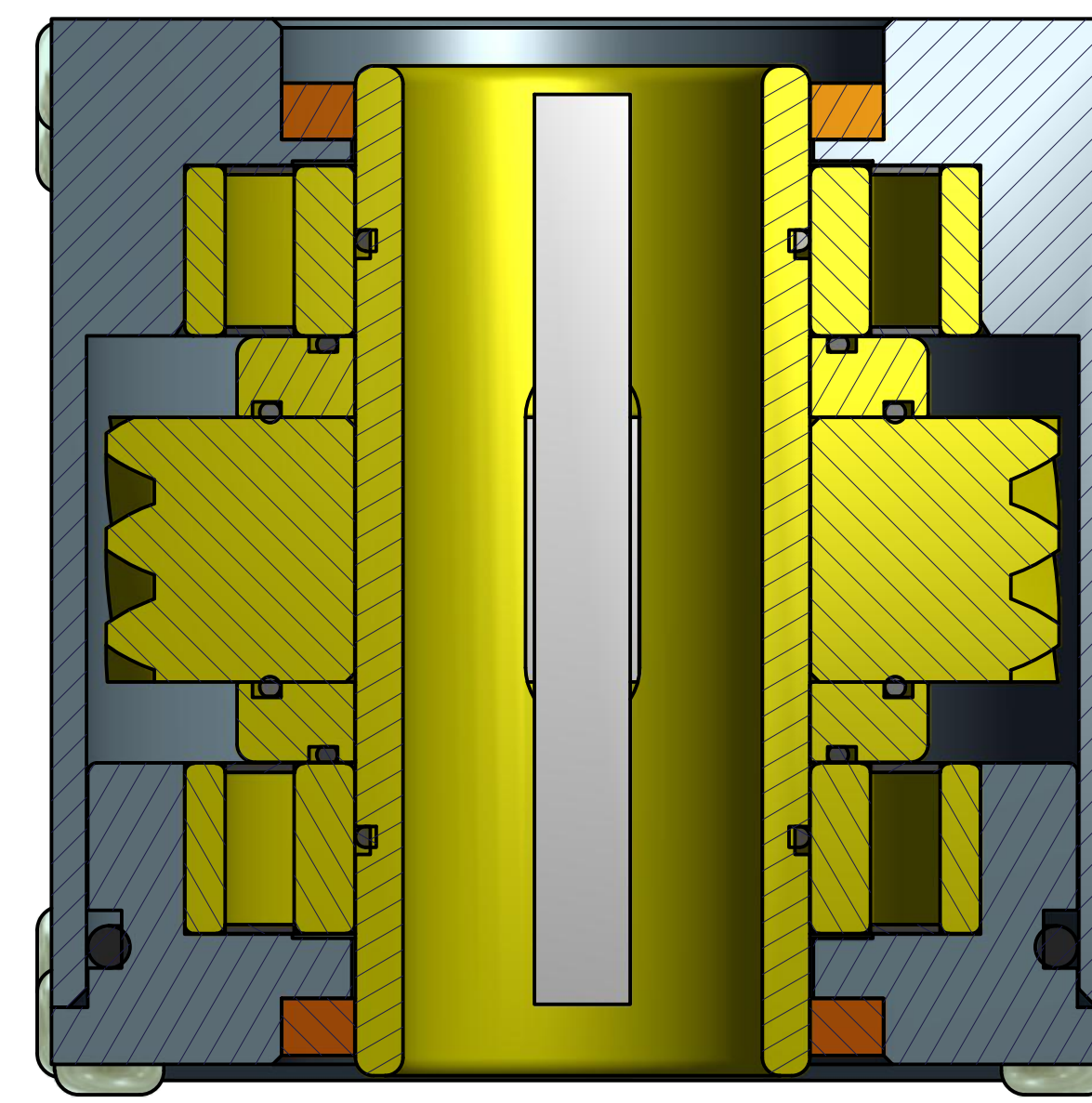

SECTION A-A
SCALE 1.7

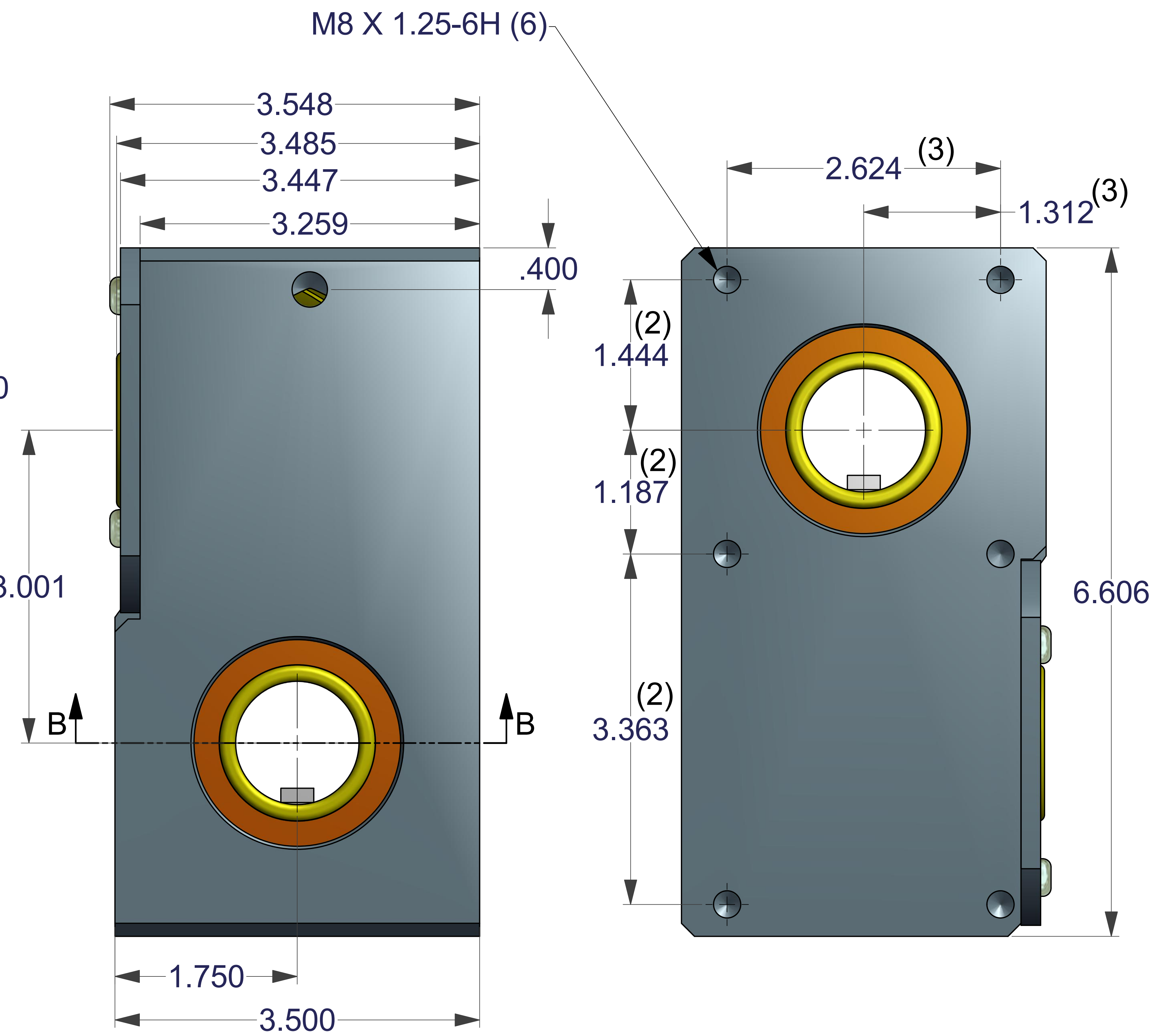
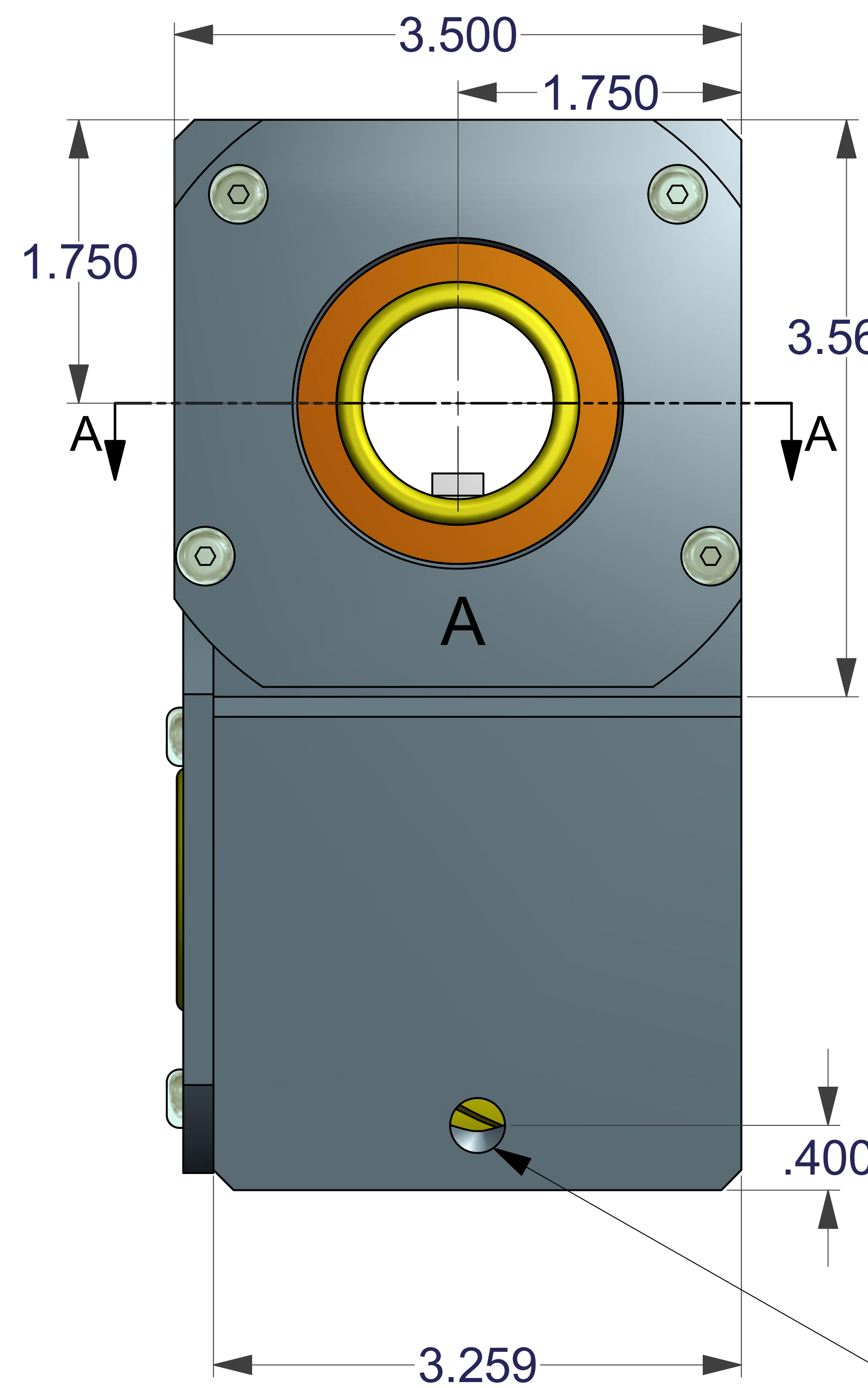
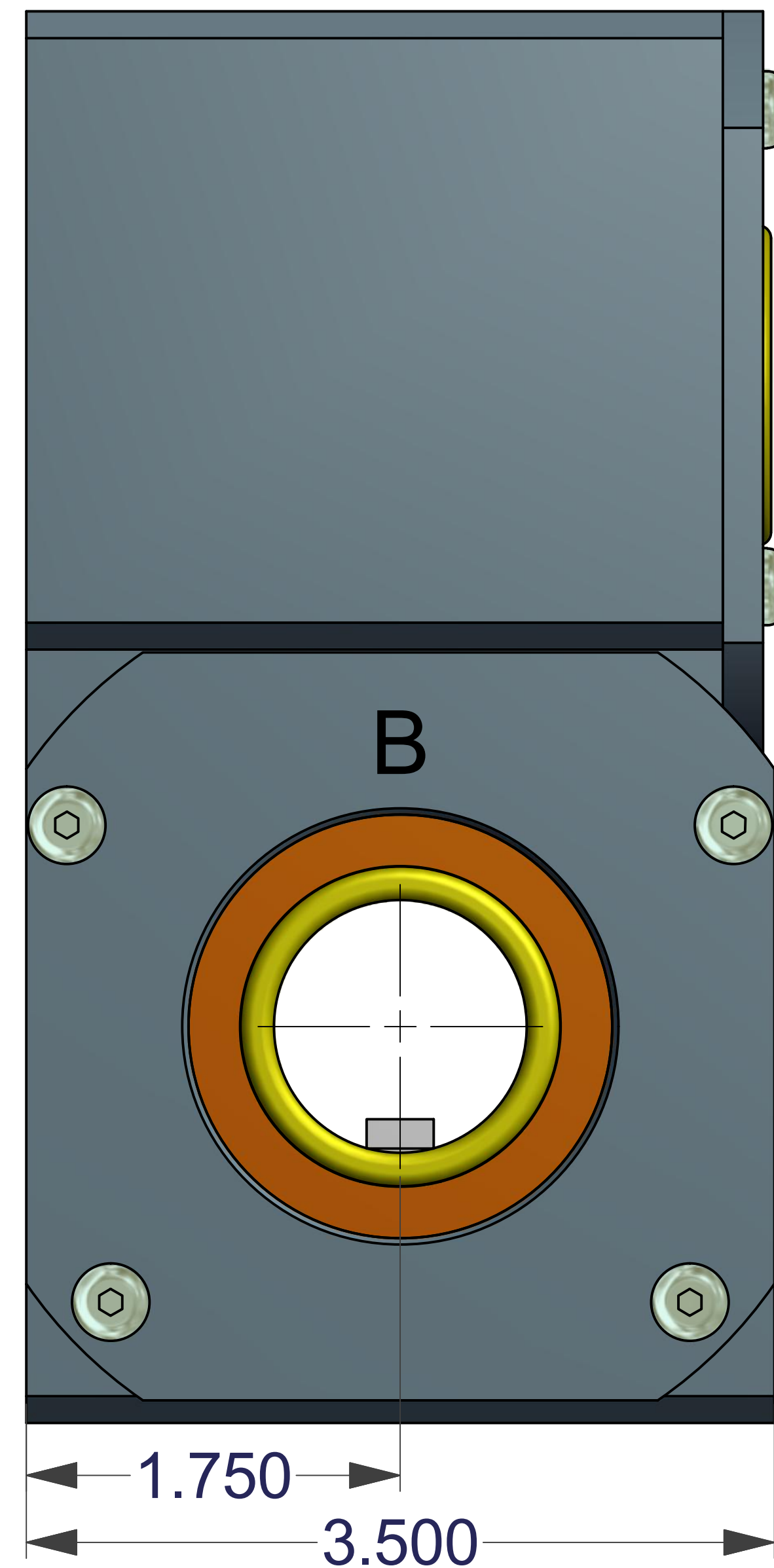

BREATHER/FILL PORTS (2)
1/8-27 NPTF

SPRING LOADED SHAFT SEALS (4)

PART NUMBER	TYPE	A-BORE	B-BORE
4306-0652	RH	30mm	30mm
4306-0653	LH	30mm	30mm
4306-0654	RH	30mm	25mm
4306-0655	LH	30mm	25mm
4306-0656	RH	30mm	20mm
4306-0657	LH	30mm	20mm
4306-0658	RH	25mm	30mm
4306-0659	LH	25mm	30mm
4306-0660	RH	25mm	25mm
4306-0661	LH	25mm	25mm
4306-0662	RH	25mm	20mm
4306-0663	LH	25mm	20mm
4306-0664	RH	20mm	30mm
4306-0665	LH	20mm	30mm
4306-0666	RH	20mm	25mm
4306-0667	LH	20mm	25mm
4306-0668	RH	20mm	20mm
4306-0669	LH	20mm	20mm

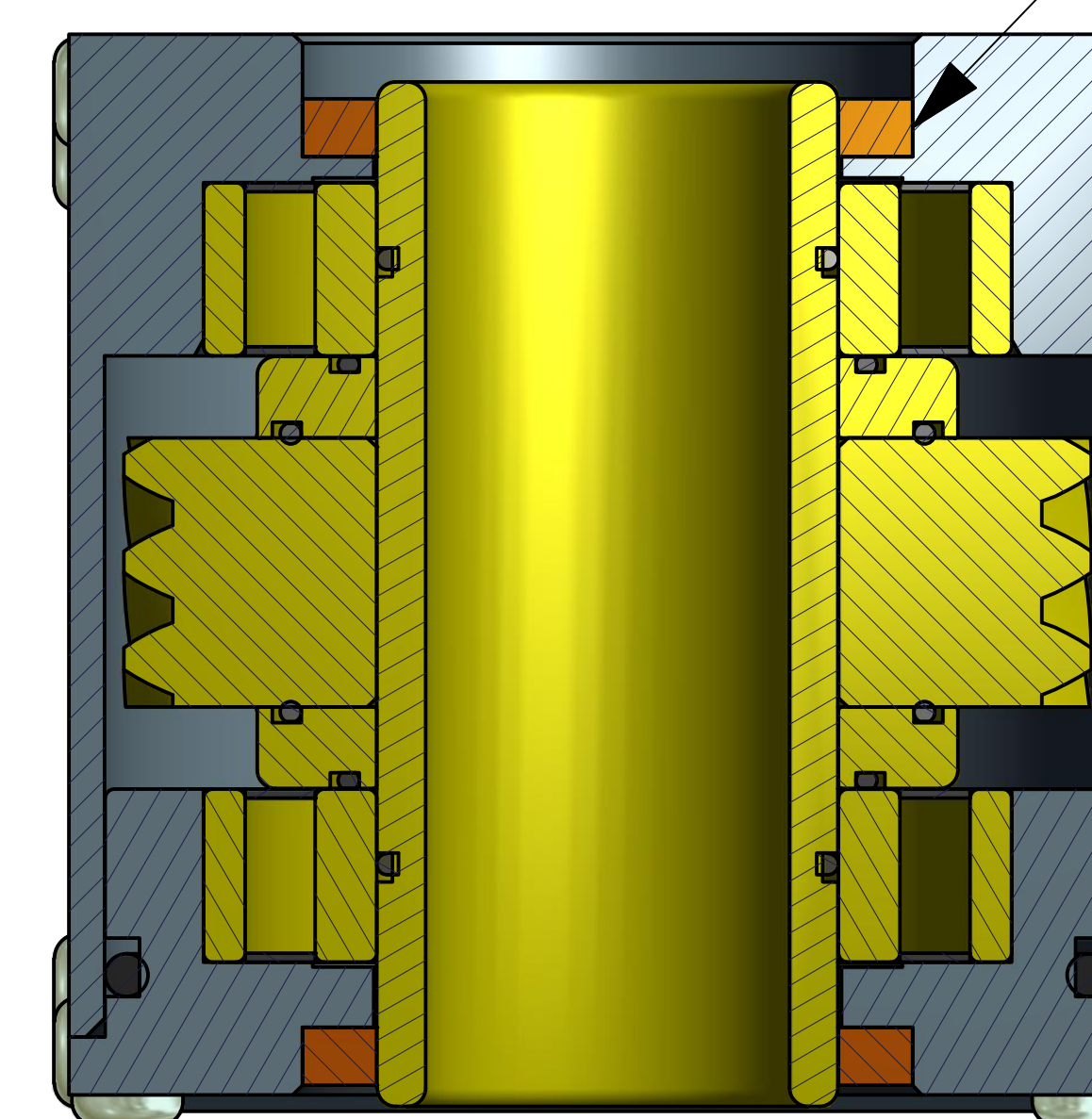

SECTION B-B
SCALE 1.7

- * 8620 HEAT TREATED GEARS
- * (4) DBL. SEALED R24 BALL BEARINGS
- * ANODIZED ALUMINUM HOUSINGS & CAPS
- * AVAILABLE IN ALL STAINLESS
- * AVAILABLE WITH ELECTRO NICKEL HOUSINGS & CAPS PLUS ALL STAINLESS FASTENERS.

INSERT-A-SHAFT METRIC CRL SERIES 30
1:1 RATIO 3.0 IN. SHAFT CENTERS

UNLESS OTHERWISE SPECIFIED: DO NOT SCALE DRAWING REMOVE ALL BURRS TAP DEPTHS FULL THD. DRILL DEPTHS FULL DIA.	DESIGNER	DATE	W.C. BRANHAM INC. RIVER FALLS, WI.	
	WCB 06/09/11			
	TOLERANCES 2 PLACE +/- .010 3 PLACE +/- .005	CHECKER	DATE	TITLE
	THREADS EXTERNAL CLASS 2A INTERNAL CLASS 2B	SCALE		DRAWING NO.
	CLASS		REVISION	