

TOTAL PAD WEAR, INCHES	TANGENTIAL FORCE, LBS.
0	3,059
.06	2,622
.12	2,185
.18	1,748
.24	1,311
.30	874
.36	437
.42	0

- * 6,798 LBS. OF CLAMPING FORCE
- * .45 COFF. OF FRICTION PAD # 951023
- * 400 PSI RELEASE PRESSURE
- * CAST ALUMINUM CONSTRUCTION
- * HARDCOATED HOUSINGS
- * 14.14 SQ. IN. TOTAL FRICTION AREA
- * 4.64 CUBIC INCHES WEARABLE MATERIAL
- * BUNA N & URATHANE SEALS
- * NON ASBESTOS FRICTION MATERIAL
- * 14 IN. MINIMUM DISC DIAMETER
- * MAX. DISC DIAMETER - UNLIMITED
- * 26.79 SQ. INCHES OF RETRACT PISTON AREA

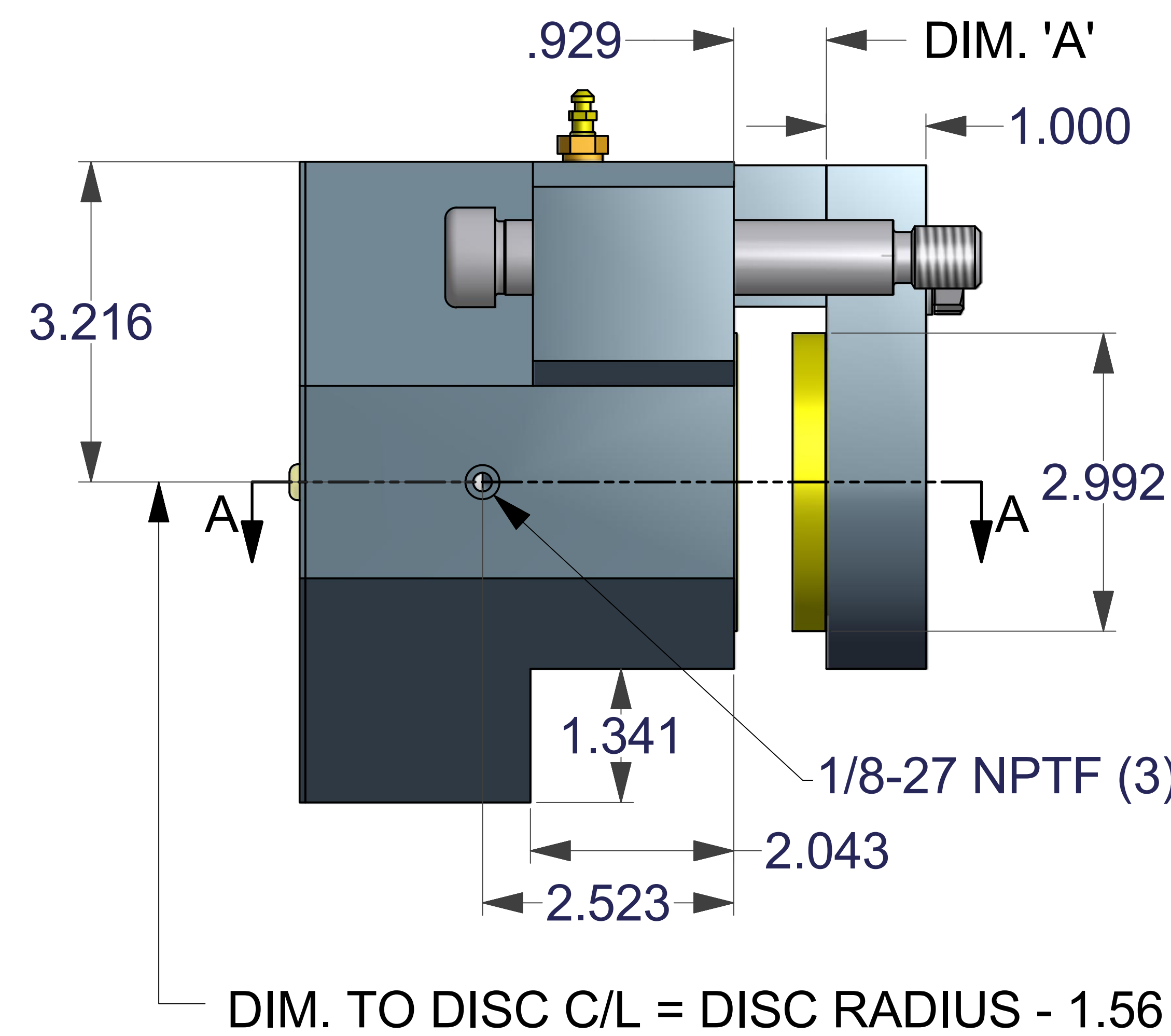
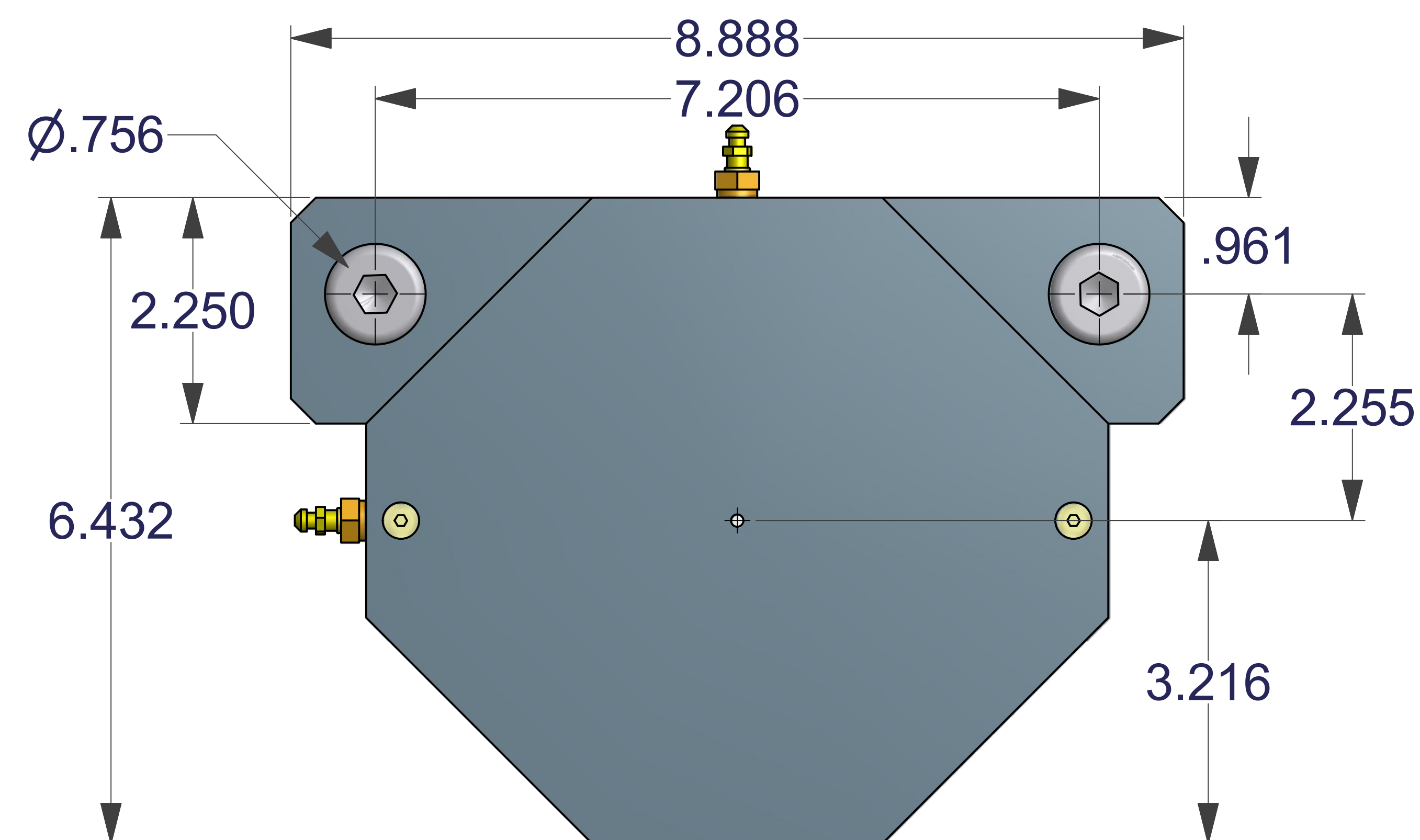
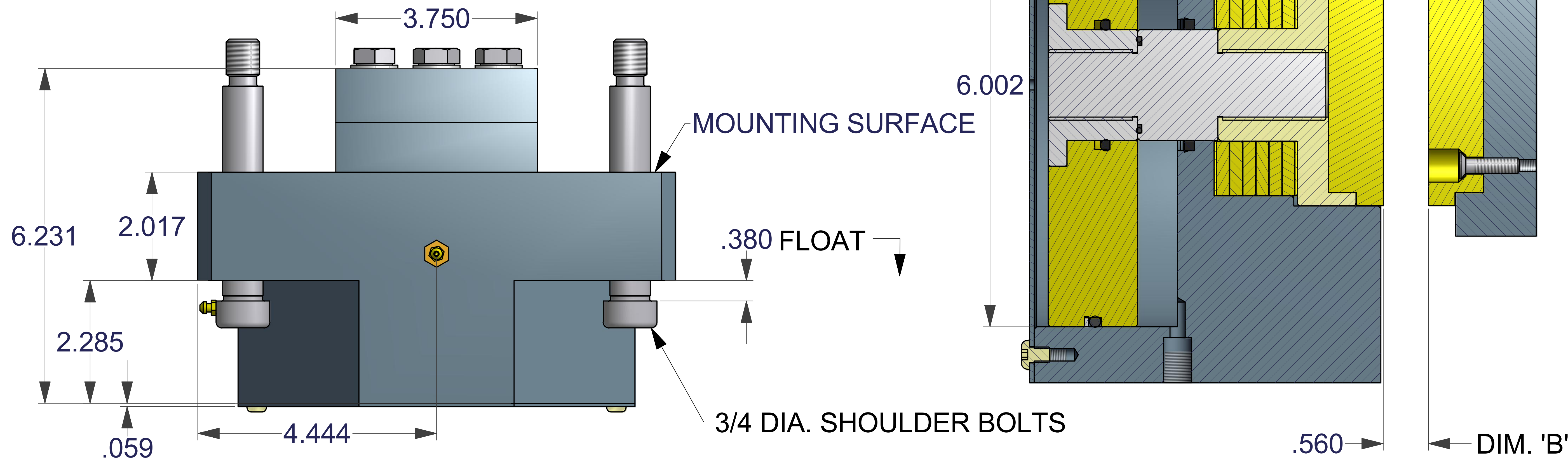

DISC THK.	DIM. 'A'	DIM. 'B'
1/4	.679	.310
3/8	.804	.435
1/2	.929	.560
5/8	1.054	.685
3/4	1.179	.810
1.0	1.429	1.060
1.125	1.554	1.185

PART NO.	MODEL	DISC THK.
4006-0028	FS510SB	1/4
4006-0029	FS510SL	3/8
4006-0030	FS510SE	1/2
4006-0031	FS510SJ	5/8
4006-0032	FS510ST	3/4
4006-0033	FS510SO	1.0
4006-0034	FS510SQ	1.125

DISC DIA.	BRAKING RADIUS
14	5.44
16	6.44
18	7.44
20	8.44
30	13.44

- * FS510 SERIES BRAKES ARE FOR EMERGENCY STOP & HOLDING ONLY
- * DISC SPACERS ARE AVAILABLE FOR OTHER DISC THICKNESSES
- * TORQUE, IN. LBS. = DISC RADIUS - 1.56 x TANGENTIAL FORCE, LBS.
- * THREE 1/8-27 NPTF PORTS

UNLESS OTHERWISE SPECIFIED: DO NOT SCALE DRAWING REMOVE ALL BURRS TAP DEPTHS FULL THD. DRILL DEPTHS FULL DIA.	THIRD ANGLE PROJECTION	DESIGNER WCB 08/04/10	DATE DATE	W.C. BRANHAM INC. RIVER FALLS, WI.	
	TOLERANCES 2 PLACE +/- .010 3 PLACE +/- .005				CHECKER
	THREADS EXTERNAL CLASS 2A INTERNAL CLASS 2B	SCALE	CLASS		TITLE FS510S SERIES
	SIZE E	DRAWING NO.	REVISION		