

| TOTAL PAD WEAR, INCHES | TANGENTIAL FORCE, LBS. |
|------------------------|------------------------|
| 0 | 3,059 |
| .06 | 2,622 |
| .12 | 2,185 |
| .18 | 1,748 |
| .24 | 1,311 |
| .30 | 874 |
| .36 | 437 |
| .42 | 0 |

FS525 SERIES BRAKES ARE FOR EMERGENCY STOP & HOLDING APPLICATIONS ONLY. DISC SPACERS ARE AVAILABLE FOR OTHER DISC THICKNESSES.

- * 6,798 LBS. OF CLAMPING FORCE
- * .45 COFF. OF FRICTION. PAD #951023
- * TORQUE, IN. LBS. = DISC RADIUS - 1.56
- x TANGENTIAL FORCE
- * 200 PSI RELEASE PRESSURE
- * 400 PSI MAXIMUM PRESSURE
- * CAST ALUM. CONSTRUCTION
- * HARDCOATED HOUSINGS
- * 14.14 SQ. IN. TOTAL FRICTION AREA
- * 4.64 TOTAL CUBIC INCHES WEARABLE MATERIAL
- * BUNA N & URATHANE SEALS
- * NON-ASBESTOS FRICTION MATERIAL
- * UNLIMITED DISC DIAMETER
- * 53.58 SQ. INCHES OF RETRACT PISTON AREA

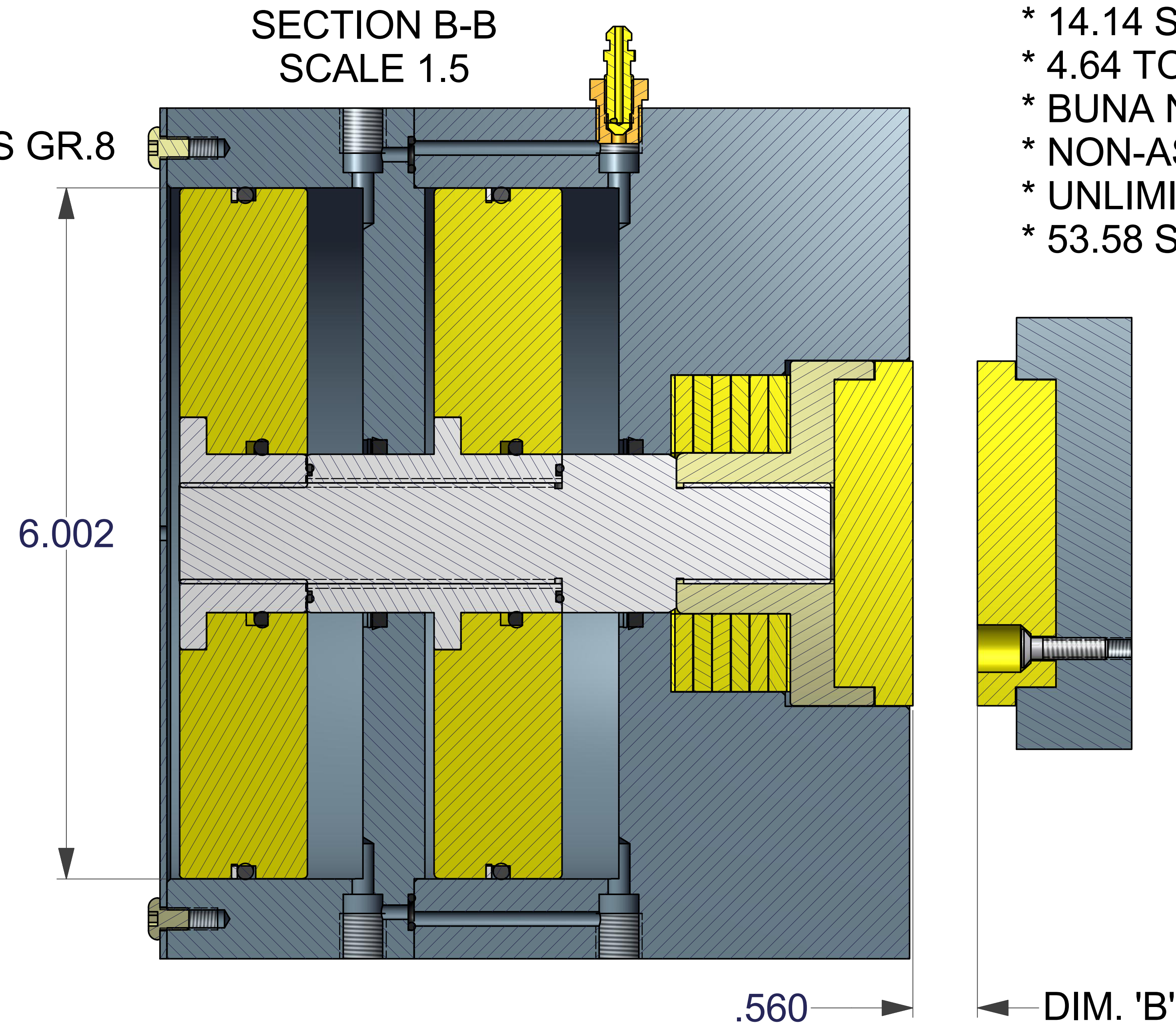
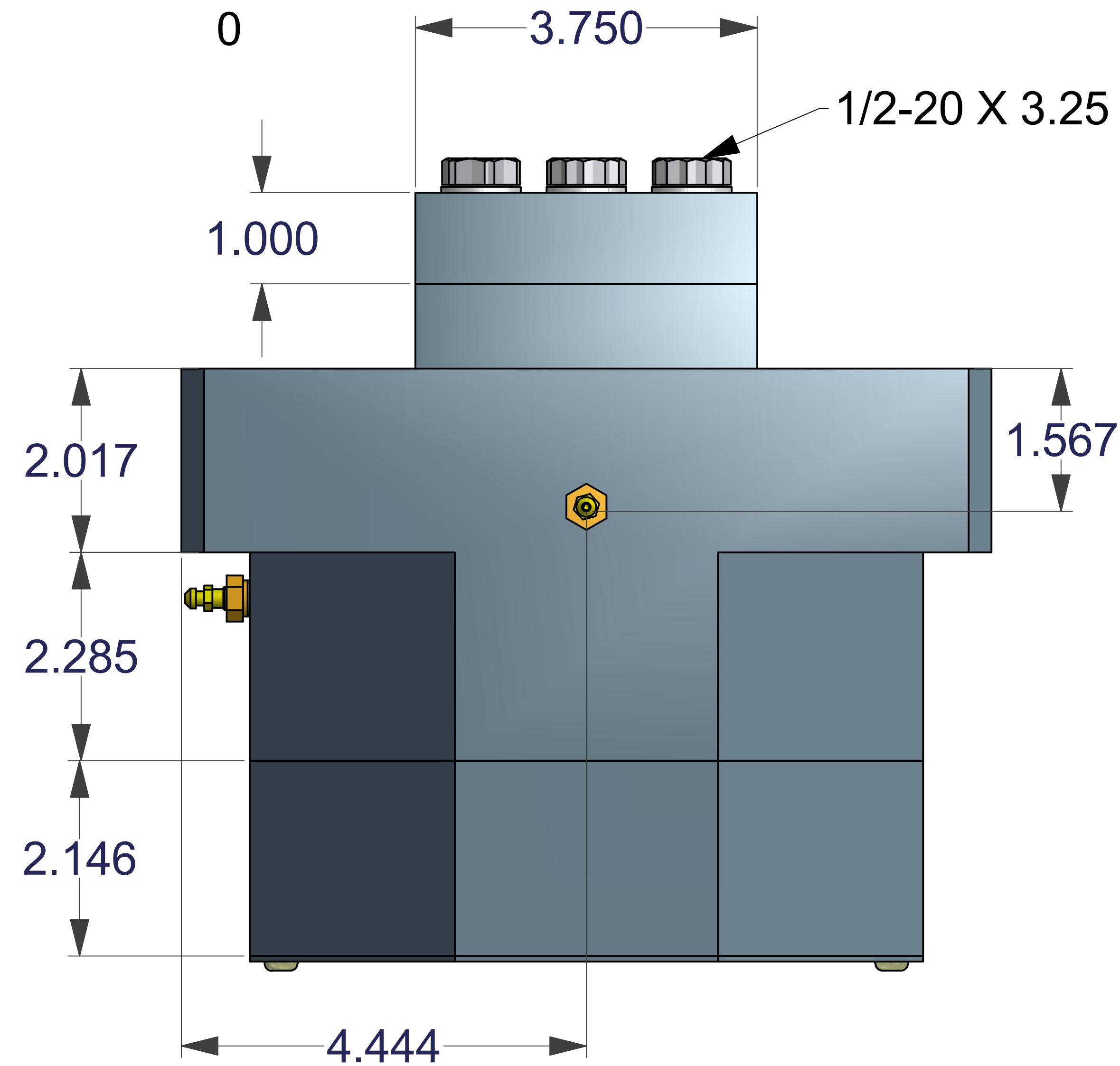

| DISC THK. | DIM. 'A' | DIM. 'B' |
|-----------|----------|----------|
| 1/4 | .679 | .310 |
| 3/8 | .804 | .435 |
| 1/2 | .929 | .560 |
| 5/8 | 1.054 | .685 |
| 3/4 | 1.179 | .810 |
| 1.0 | 1.429 | 1.060 |
| 1.125 | 1.554 | 1.185 |

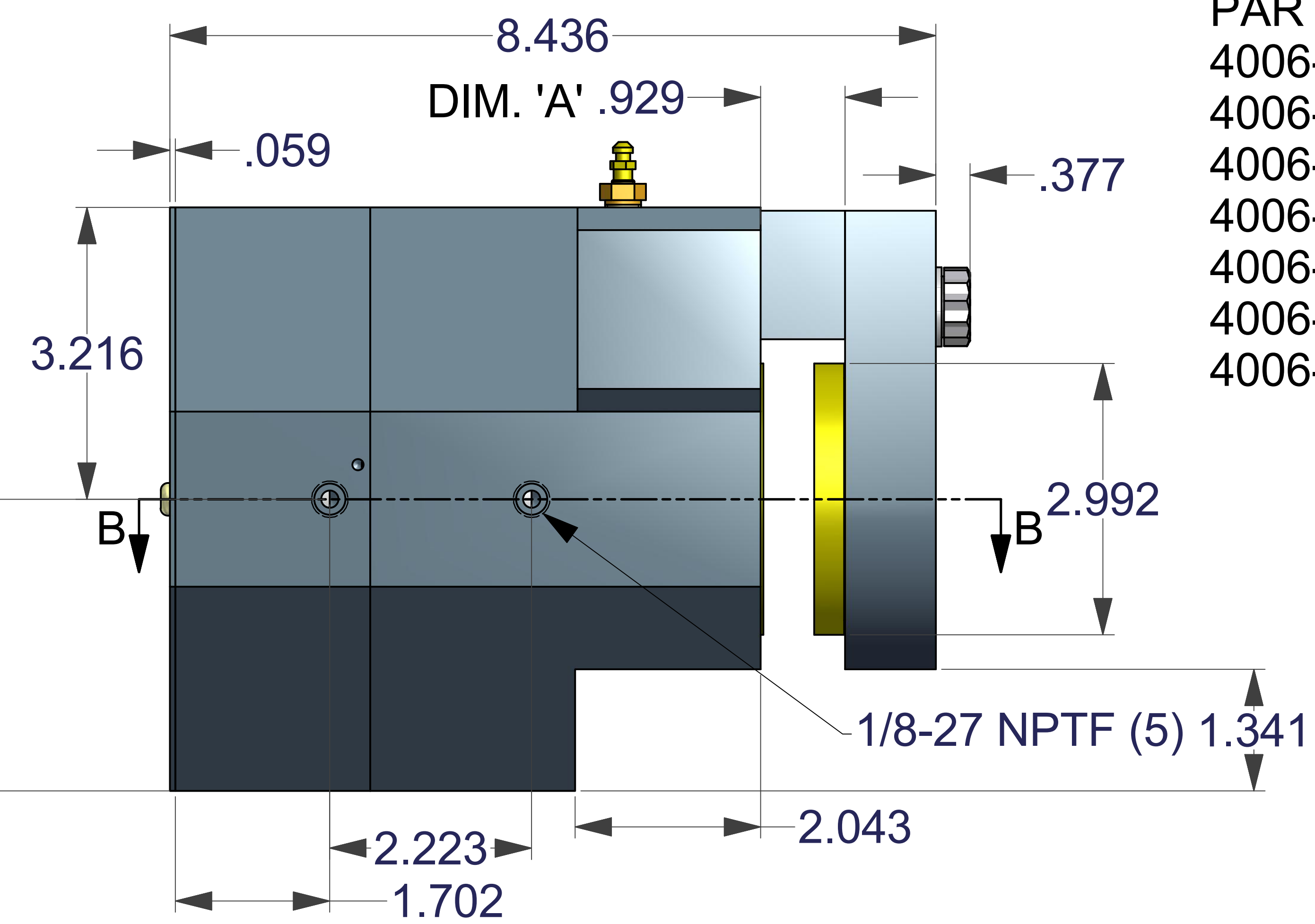
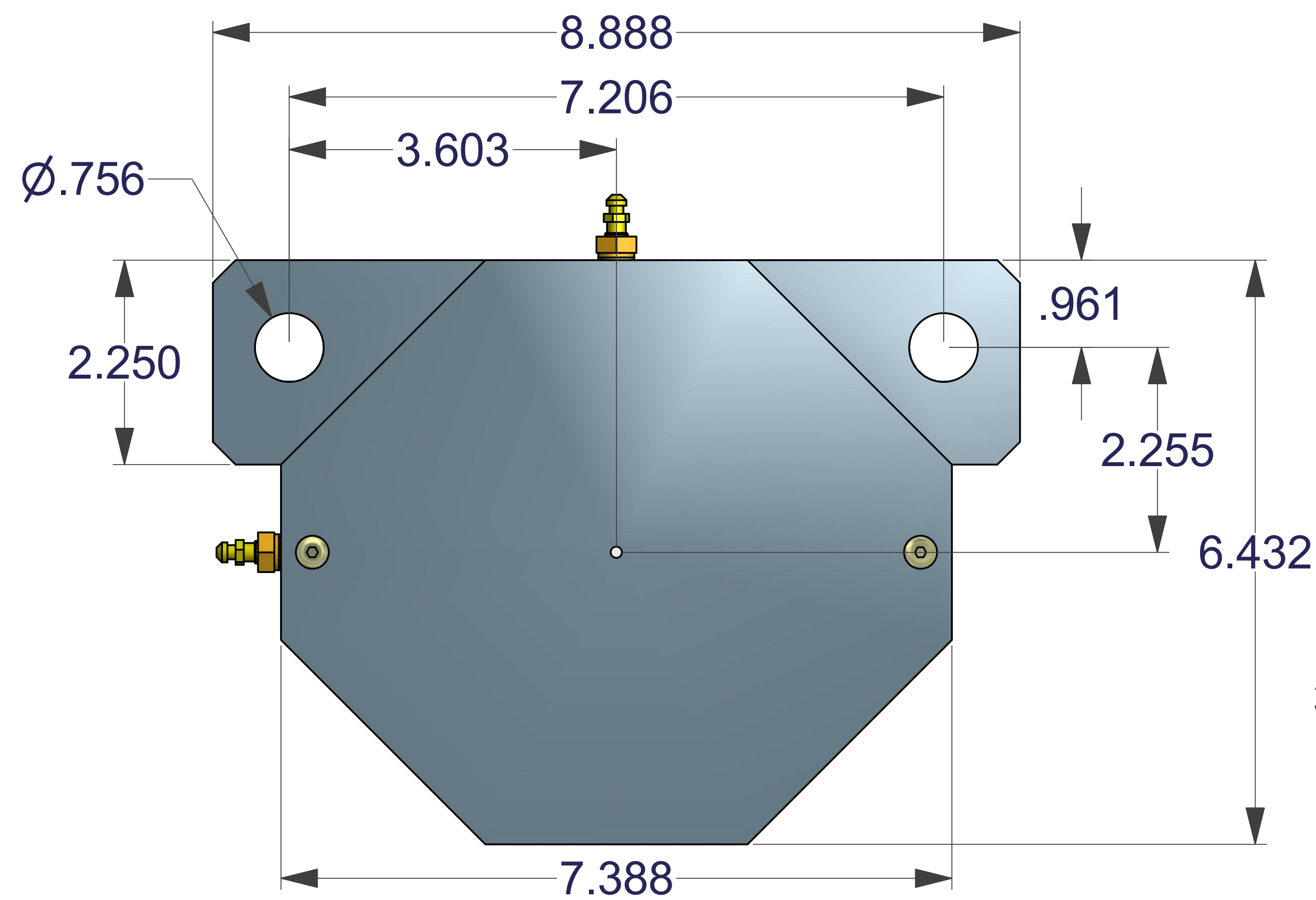

| PART NUMBER | MODEL | DISC THK. |
|-------------|---------|-----------|
| 4006-0000 | FS525SB | 1/4 |
| 4006-0001 | FS525SL | 3/8 |
| 4006-0002 | FA525SE | 1/2 |
| 4006-0003 | FS525SJ | 5/8 |
| 4006-0004 | FS525ST | 3/4 |
| 4006-0005 | FS525SO | 1.0 |
| 4006-0006 | FS525SQ | 1.125 |

| DISC DIA. | BRAKING RADIUS |
|-----------|----------------|
| 14 | 5.44 |
| 16 | 6.44 |
| 18 | 7.44 |
| 20 | 8.44 |
| 30 | 13.44 |

DIM. TO DISC C/L = DISC RADIUS - 1.56

| | | | |
|---|--|---------------------------------------|--------------------------|
| UNLESS OTHERWISE SPECIFIED: DO NOT SCALE DRAWING REMOVE ALL BURRS TAP DEPTHS FULL THD. DRILL DEPTHS FULL DIA. | THIRD ANGLE PROJECTION | W.C. BRANHAM INC. RIVER FALLS, WI. | |
| | TOLERANCES 2 PLACE +/- .010 3 PLACE +/- .005 | | DESIGNER WCB 03/15/11 |
| | THREADS EXTERNAL CLASS 2A INTERNAL CLASS 2B | | CHECKER |
| | SCALE | | DATE |
| CLASS | | TITLE FS525S SERIES | |
| | | DRAWING NO. | |
| | | REVISION | |

SIZE E