

TOTAL PAD WEAR, INCHES	TANGENTIAL FORCE, LBS.
0	3,059
.06	2,622
.12	2,185
.18	1,748
.24	1,311
.30	874
.36	437
.42	0

FS525 SERIES BRAKES ARE FOR EMERGENCY STOP & HOLDING APPLICATIONS ONLY. DISC SPACERS ARE AVAILABLE FOR OTHER DISC THICKNESSES.

- * 6,798 LBS. OF CLAMPING FORCE
- * .45 COFF. OF FRICTION. PAD #951023
- * TORQUE, IN. LBS. = DISC RADIUS - 1.56
- * x TANGENTIAL FORCE
- * 150 PSI RELEASE PRESSURE
- * 500 PSI MAXIMUM PRESSURE
- * CAST ALUM. CONSTRUCTION
- * HARDCOATED HOUSINGS
- * 14.14 SQ. IN. TOTAL FRICTION AREA
- * 4.64 TOTAL CUBIC INCHES WEARABLE MATERIAL
- * BUNA N & URATHANE SEALS
- * NON-ASBESTOS FRICTION MATERIAL
- * UNLIMITED DISC DIAMETER
- * 53.58 SQ. INCHES OF RETRACT PISTON AREA

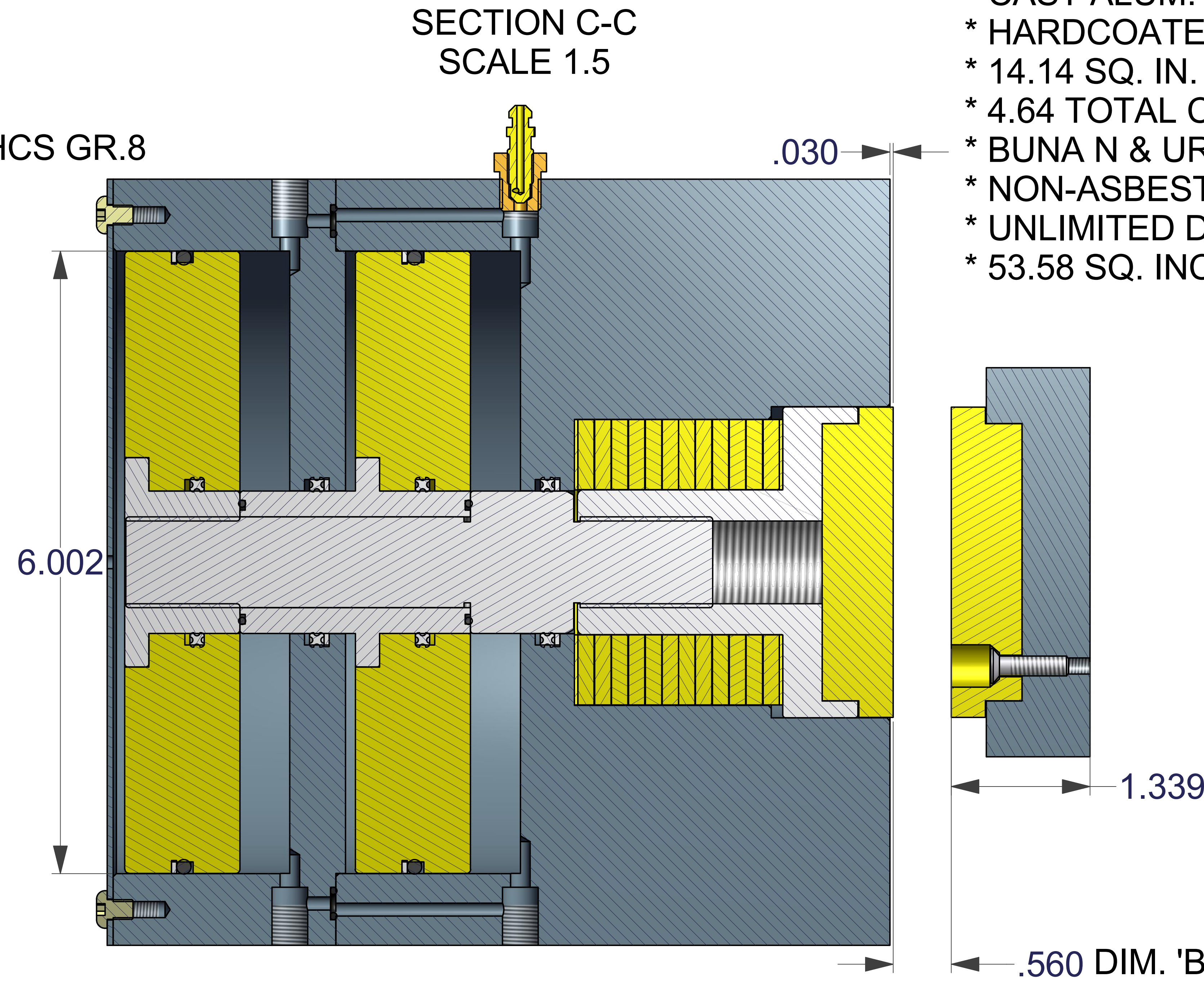
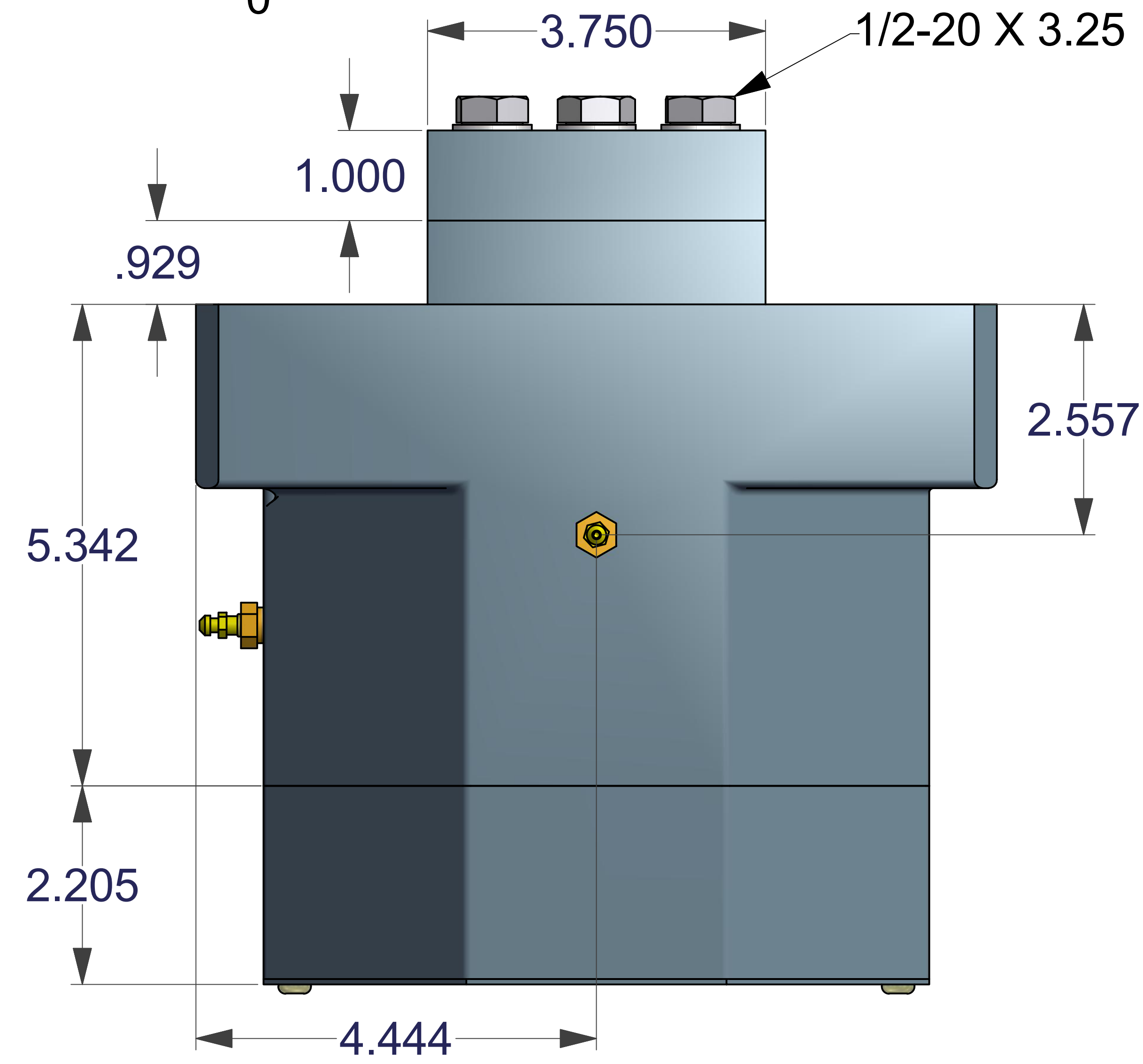

DISC THK.	DIM. 'A'	DIM. 'B'
1/4	.679	.310
3/8	.804	.435
1/2	.929	.560
5/8	1.054	.685
3/4	1.179	.810
1.0	1.429	1.060
1.125	1.554	1.185

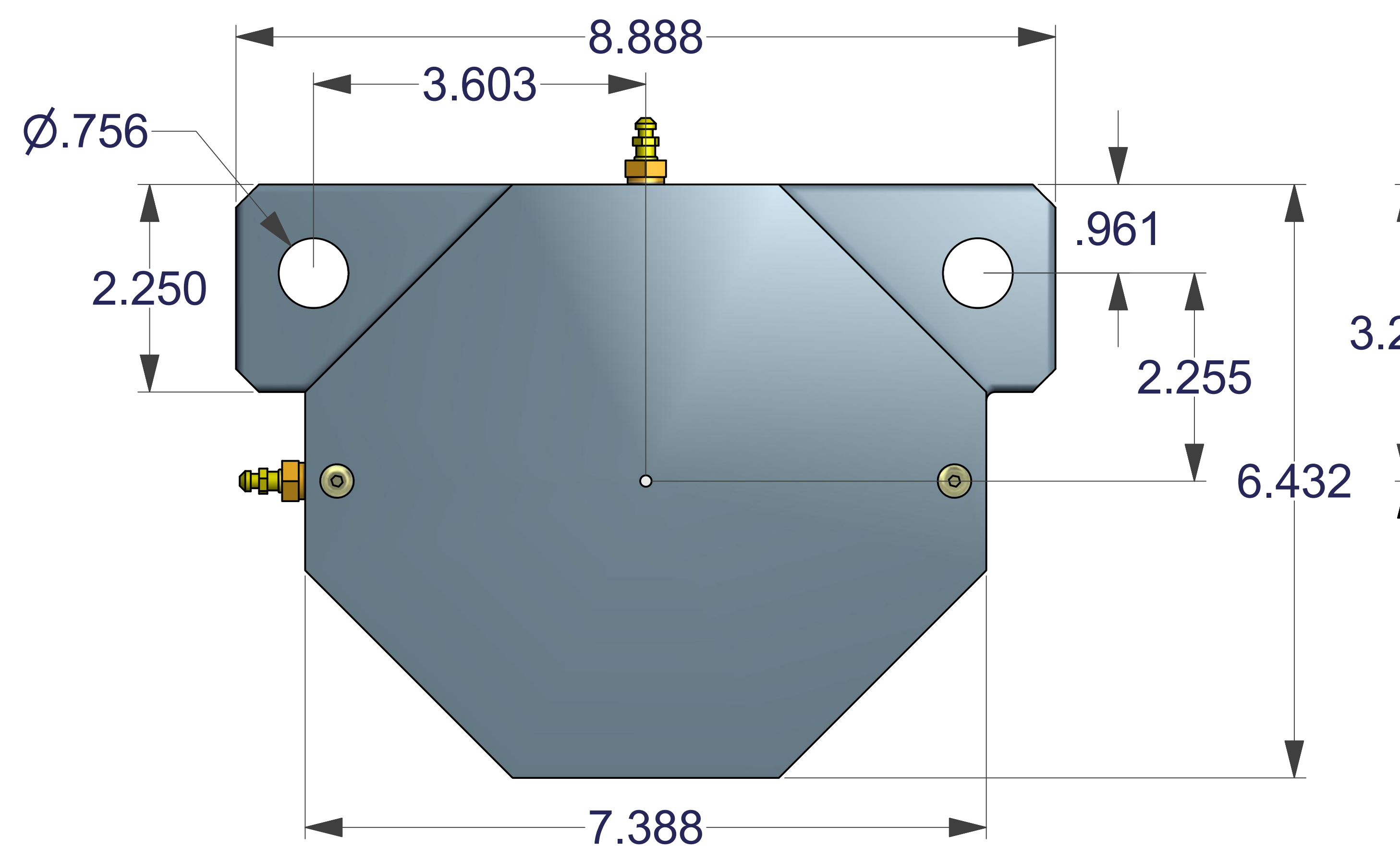

DIM. TO DISC C/L = DISC RADIUS - 1.56

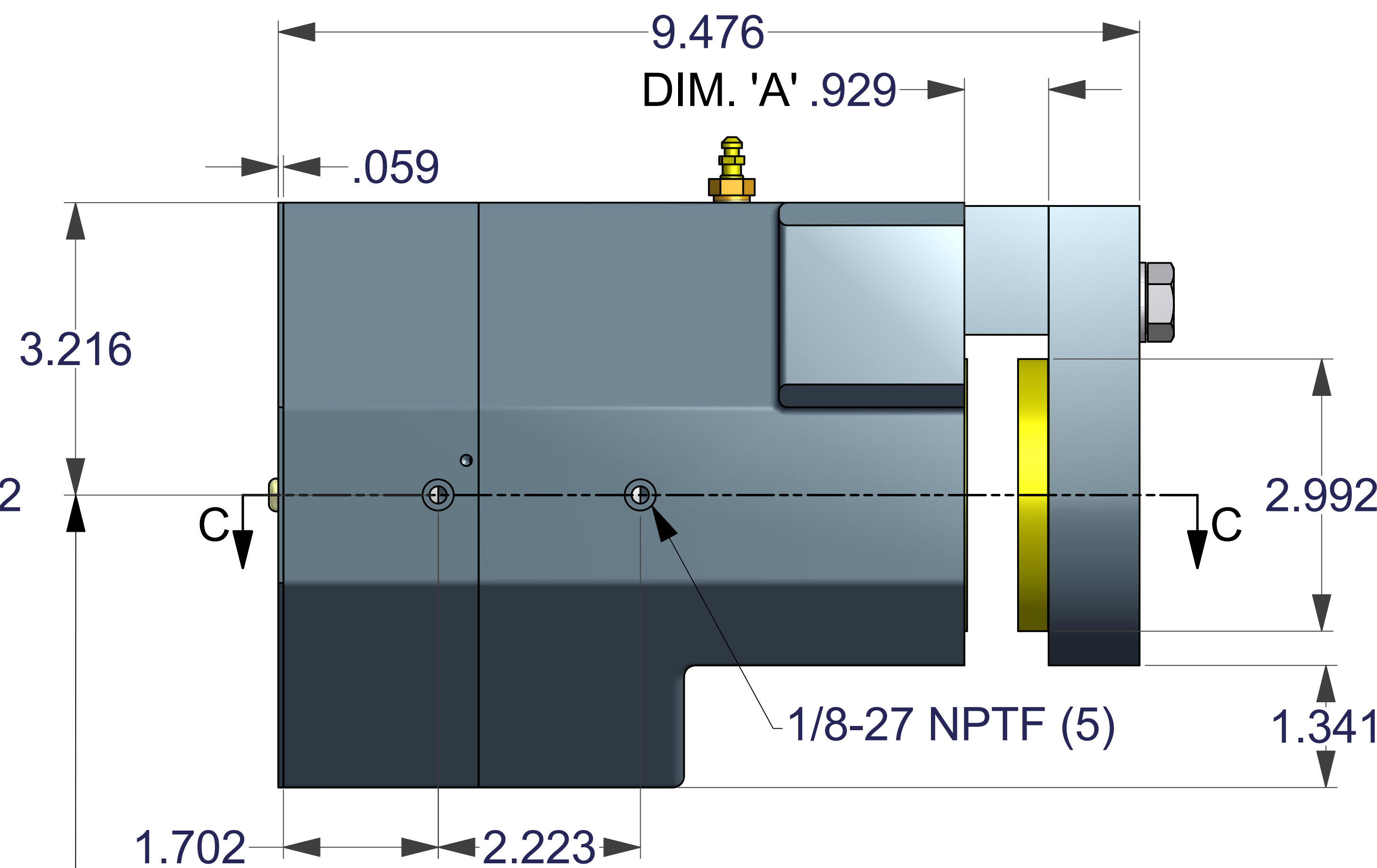

PART NUMBER	MODEL	DISC THK.
4006-0007	FS525SB	1/4
4006-0008	FS525SL	3/8
4006-0009	FS525SE	1/2
4006-0010	FS525SJ	5/8
4006-0011	FS525ST	3/4
4006-0012	FS525SO	1.0
4006-0013	FS525SQ	1.125

DISC DIA.	BRAKING RADIUS
14	5.44
16	6.44
18	7.44
20	8.44
30	13.44

UNLESS OTHERWISE SPECIFIED: DO NOT SCALE DRAWING REMOVE ALL BURRS TAP DEPTHS FULL THD. DRILL DEPTHS FULL DIA.	THIRD ANGLE PROJECTION	DESIGNER WCB 04/14/11	DATE	TITLE FS525S SERIES	SIZE E
	TOLERANCES 2 PLACE +/- .010 3 PLACE +/- .005				
	THREADS EXTERNAL CLASS 2A INTERNAL CLASS 2B	SCALE	DRAWING NO.	REVISION	
	CLASS				