

PART NUMBER	RATIO	TYPE	A-BORE	B-BORE
4305-0030	1:1 ALL	RH	30	30
4305-0031		LH	30	30
4305-0032		RH	30	25
4305-0033		LH	30	25
4305-0034		RH	30	20
4305-0035		LH	30	20
4305-0036		RH	25	30
4305-0037		LH	25	30
4305-0038		RH	25	25
4305-0039		LH	25	25
4305-0040		RH	25	20
4305-0041		LH	25	20
4305-0042		RH	20	30
4305-0043		LH	20	30
4305-0044		RH	20	25
4305-0045		LH	20	25
4305-0046		RH	20	20
4305-0047		LH	20	20

INPUT TORQUE = OUTPUT TORQUE / .6

RPM OUTPUT TORQUE, IN. LBS.

33	358
50	312
100	248
200	198
300	172
400	122
500	111
1000	90
1200	85

MAX. HAND TORQUE -- 609 IN. LBS.

KEY SIZES: BORE -- WIDTH

20	6mm
25	8mm
30	8mm

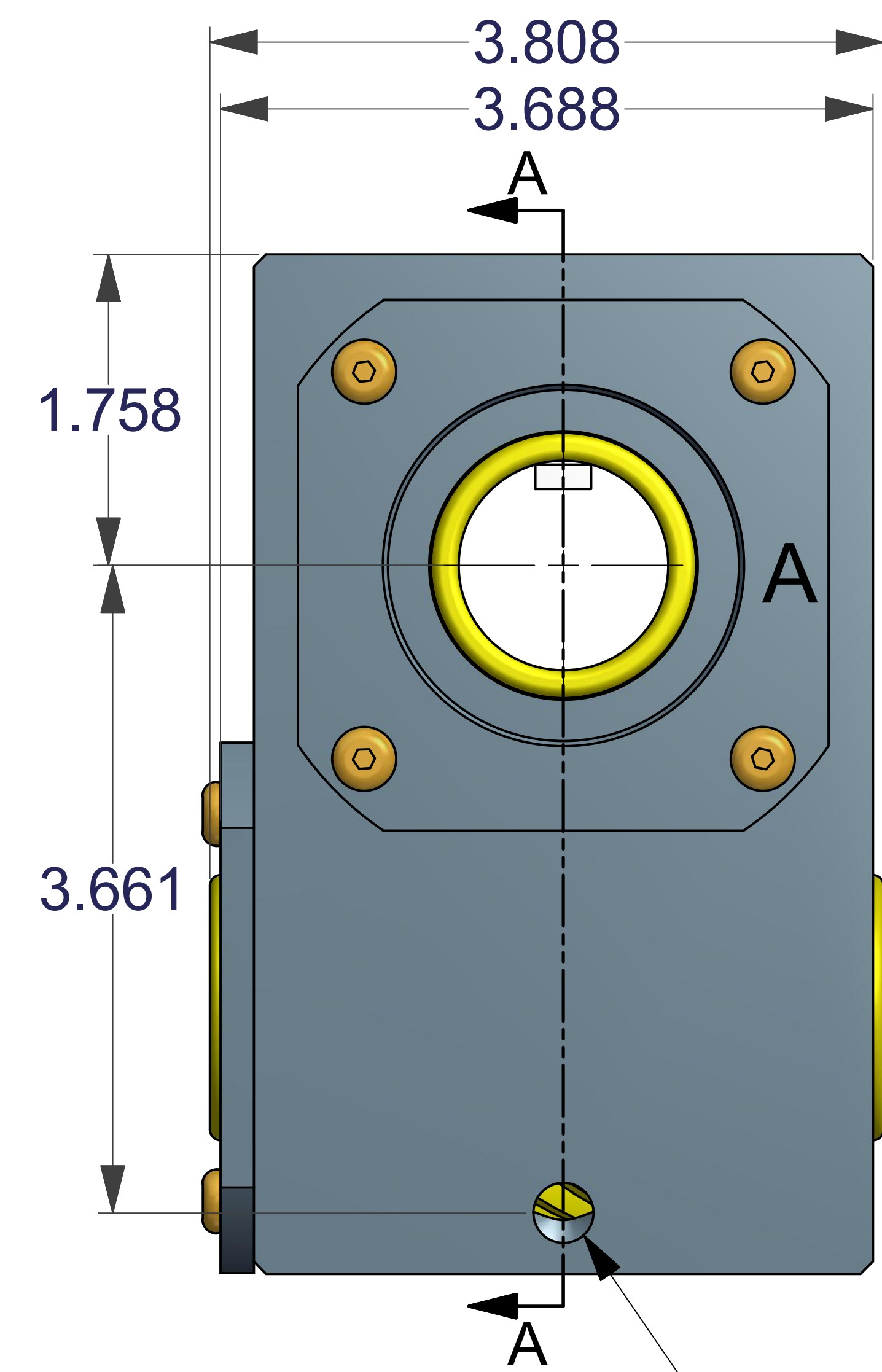
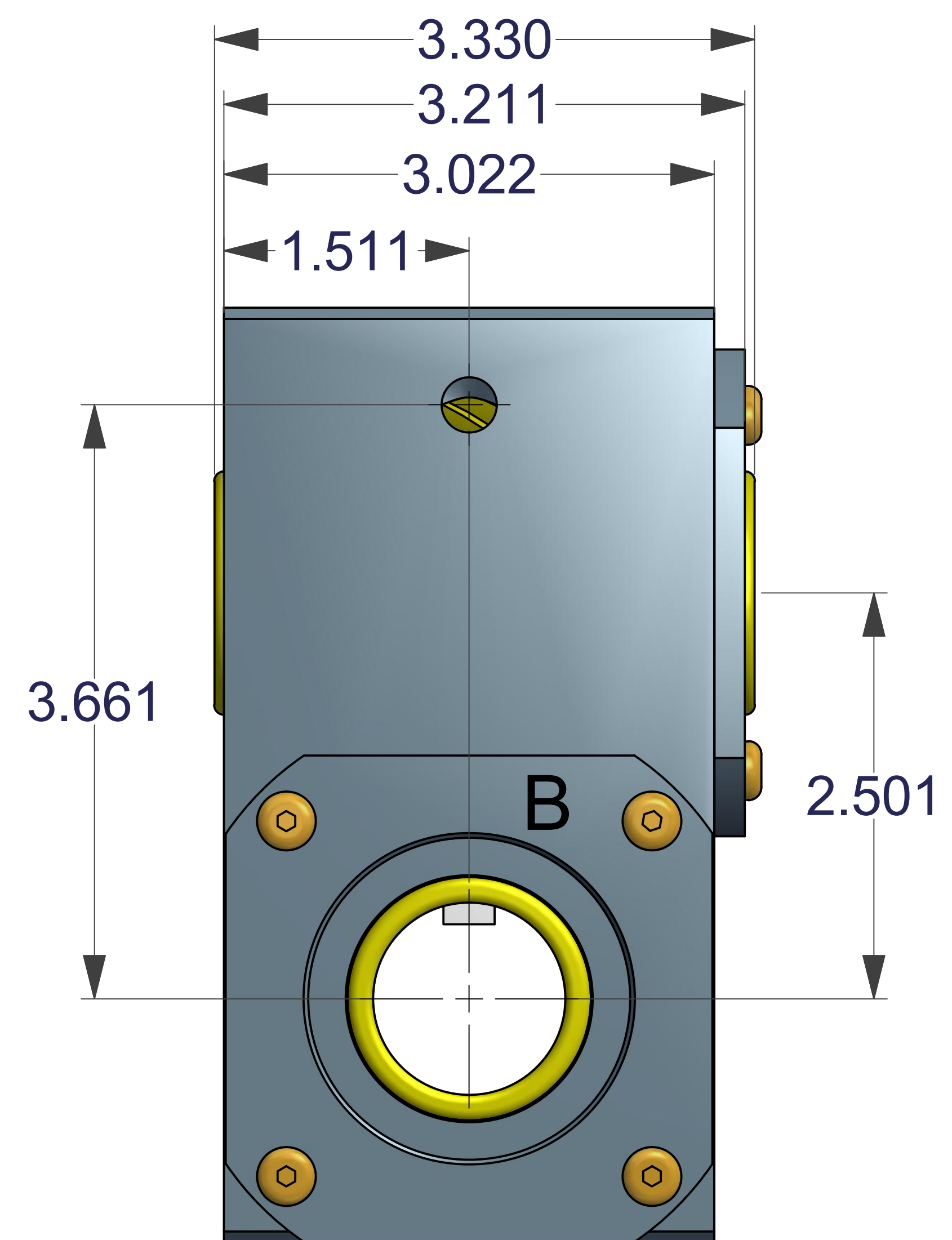
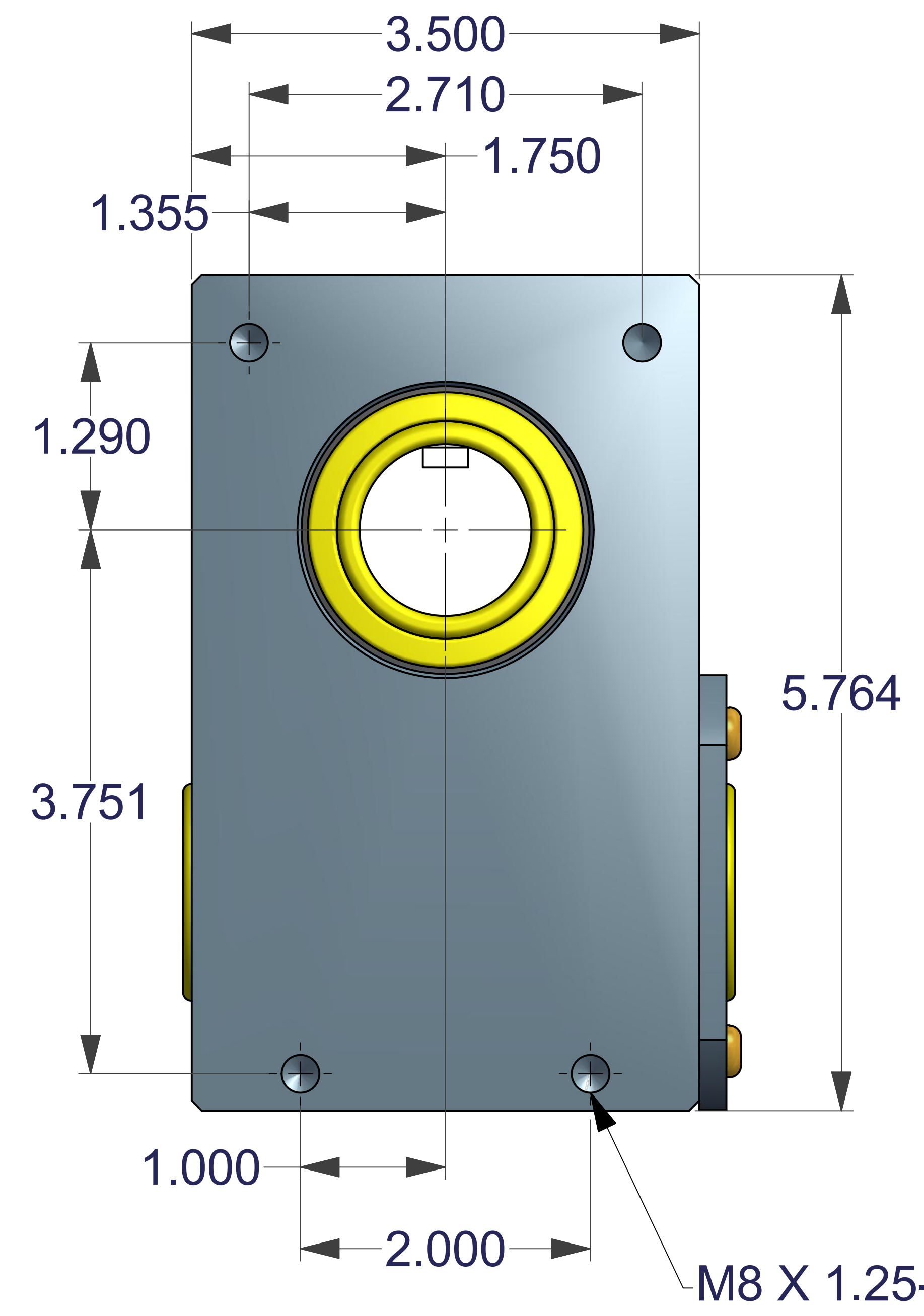
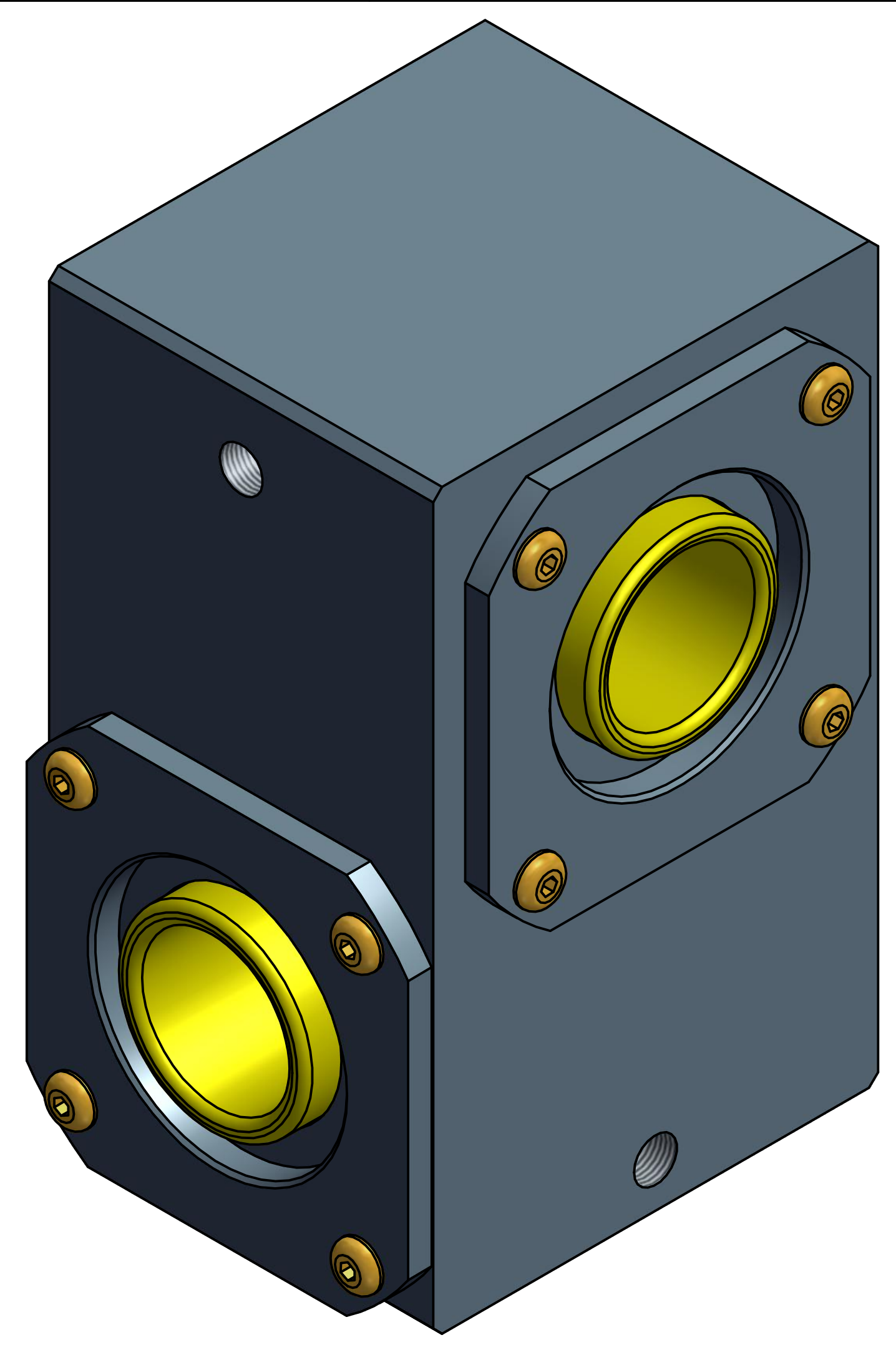

1/8 NPTF BREATHER/LUBE PORTS (2)

SECTION A-A
SCALE 1.5

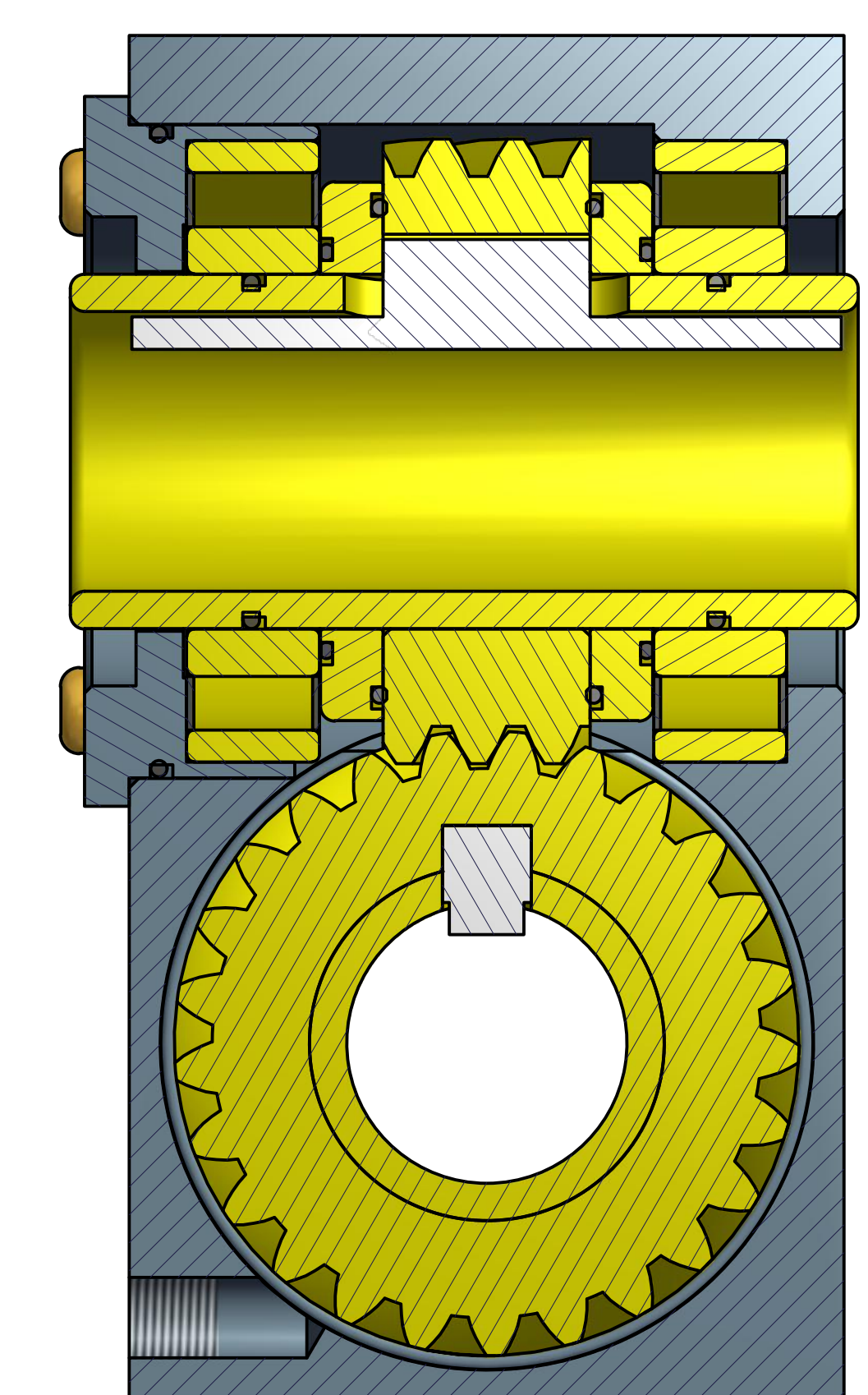

- * 8620 HEAT TREATED 25T GEARS
- * (4) DBL. SEALED R24 BALL BEARINGS
- * ANODIZED ALUMINUM HOUSING & CAPS
- * PREFILLED WITH MAGNALUBE 'G' GRADE 2

UNLESS OTHERWISE SPECIFIED: DO NOT SCALE DRAWING REMOVE ALL BURRS TAP DEPTHS FULL THD. DRILL DEPTHS FULL DIA.		THIRD ANGLE PROJECTION		W.C. BRANHAM INC. RIVER FALLS, WI.	
TOLERANCES 2 PLACE +/- .010 3 PLACE +/- .005	DESIGNER WCB	DATE 12/13/10	TITLE ALPHA STANDARD METRIC 1:1 SERIES	DRAWING NO.	REVISION
THREADS EXTERNAL CLASS 2A INTERNAL CLASS 2B	CHECKER	SCALE	CLASS		

SIZE
E