

PFS200 BRAKES ARE FOR EMERGENCY STOP & HOLDING APPLICATIONS ONLY
 DISC SPACERS ARE AVAILABLE FOR OTHER DISC THICKNESSES

SECTION F-F
 SCALE 1

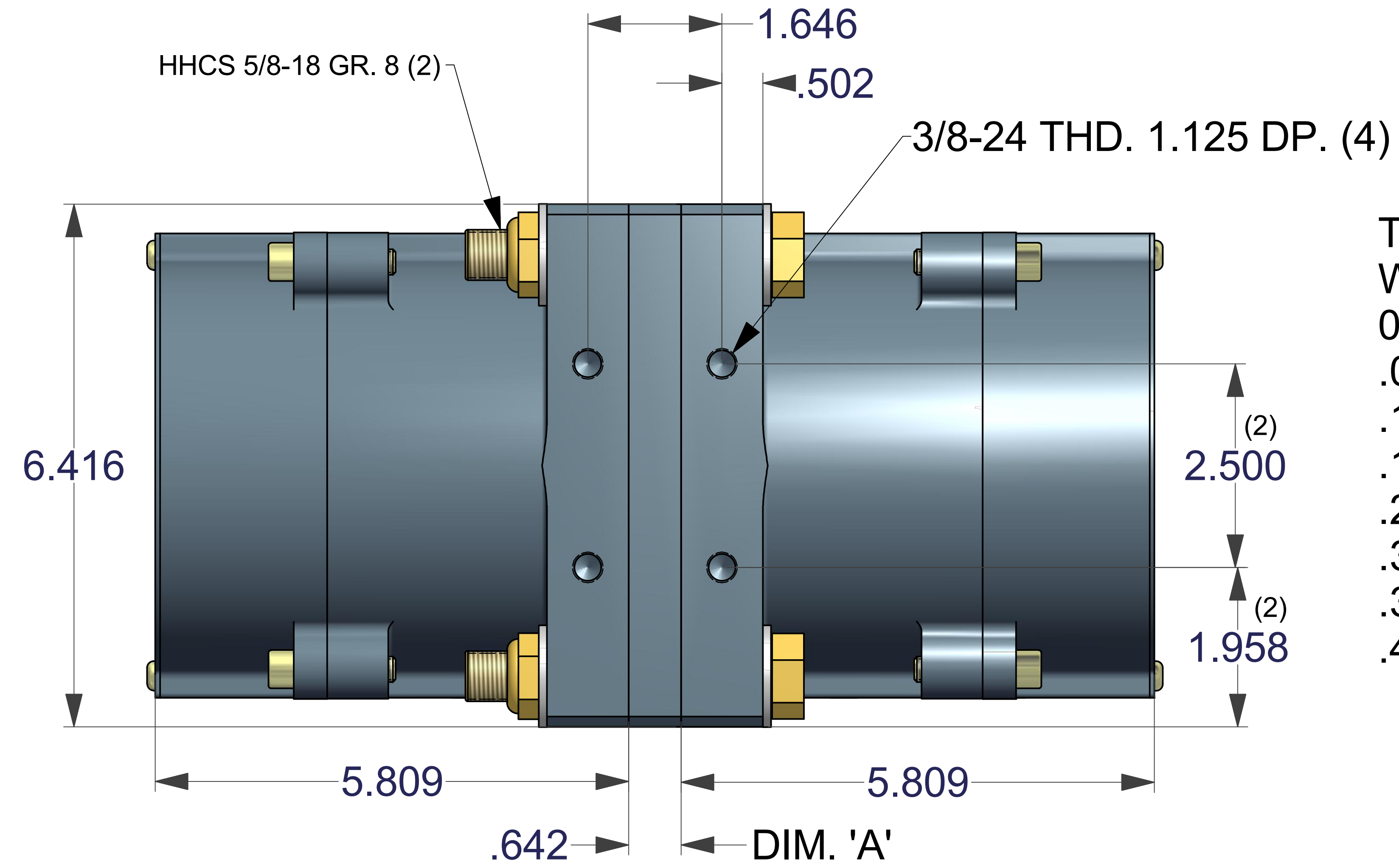
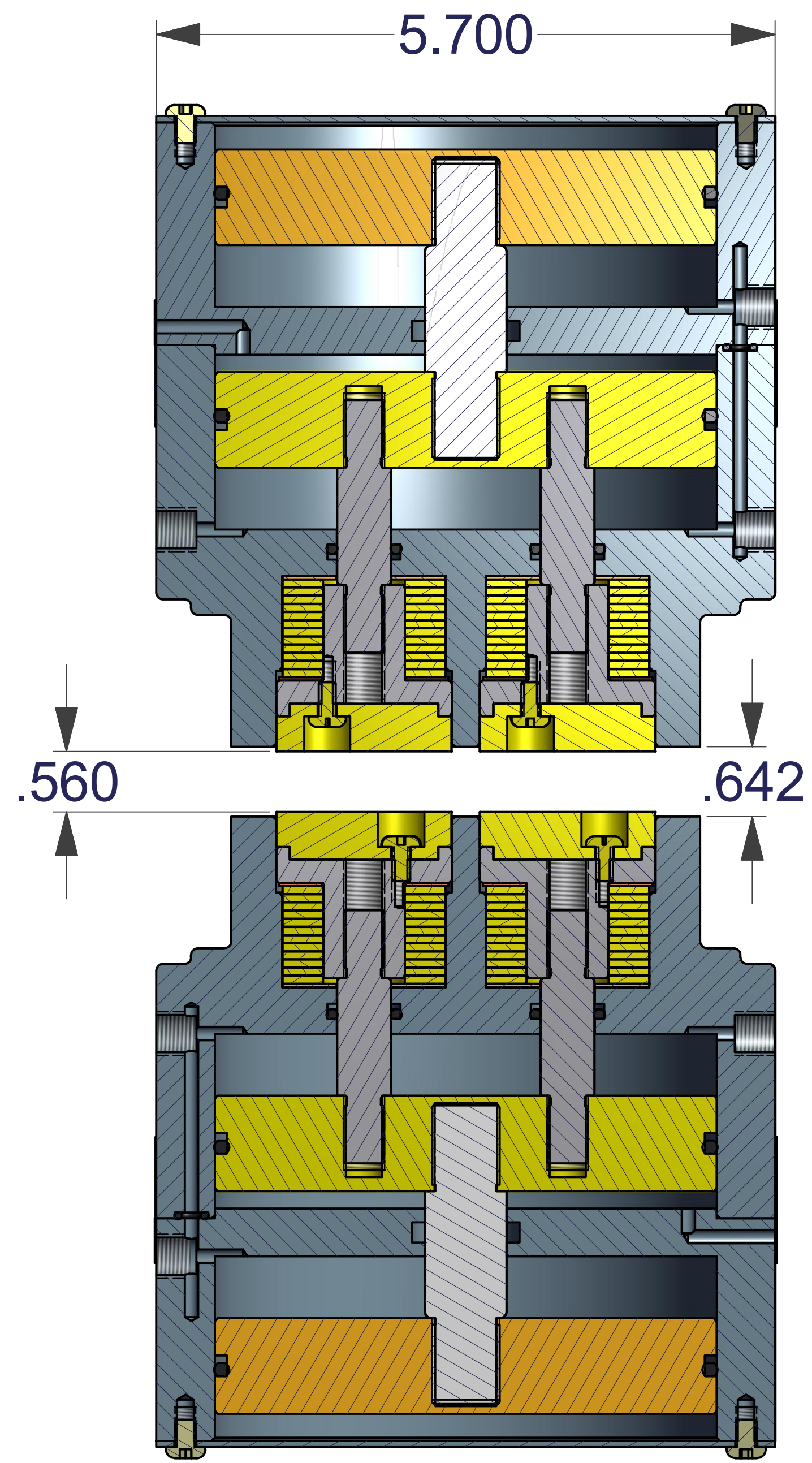

TOTAL PAD WEAR, INCHES	TANGENTIAL FORCE, LBS.
0	929
.06	796
.12	663
.18	530
.24	397
.30	264
.36	131
.42	0

BRAKING RADIUS = DISC RADIUS - .867
 TORQUE, IN. LBS. = TANGENTIAL FORCE (LBS.) X BRAKING RADIUS (IN.)

PART NO.	MODELS	DISC THK.
4005-0038	PFS200DAUL	5/32
4005-0039	PFS200DBUL	1/4
4005-0040	PFS200DLUL	3/8
4005-0041	PFS200DEUL	1/2
4005-0042	PFS200DJUL	5/8
4005-0043	PFS200DTUL	3/4
4005-0044	PFS200DOUL	1.0
4005-0045	PFS200DQUL	1.125

CALIPER HAS CROSSOVER PORTING.
 ONLY ONE CONNECTION IS REQUIRED.

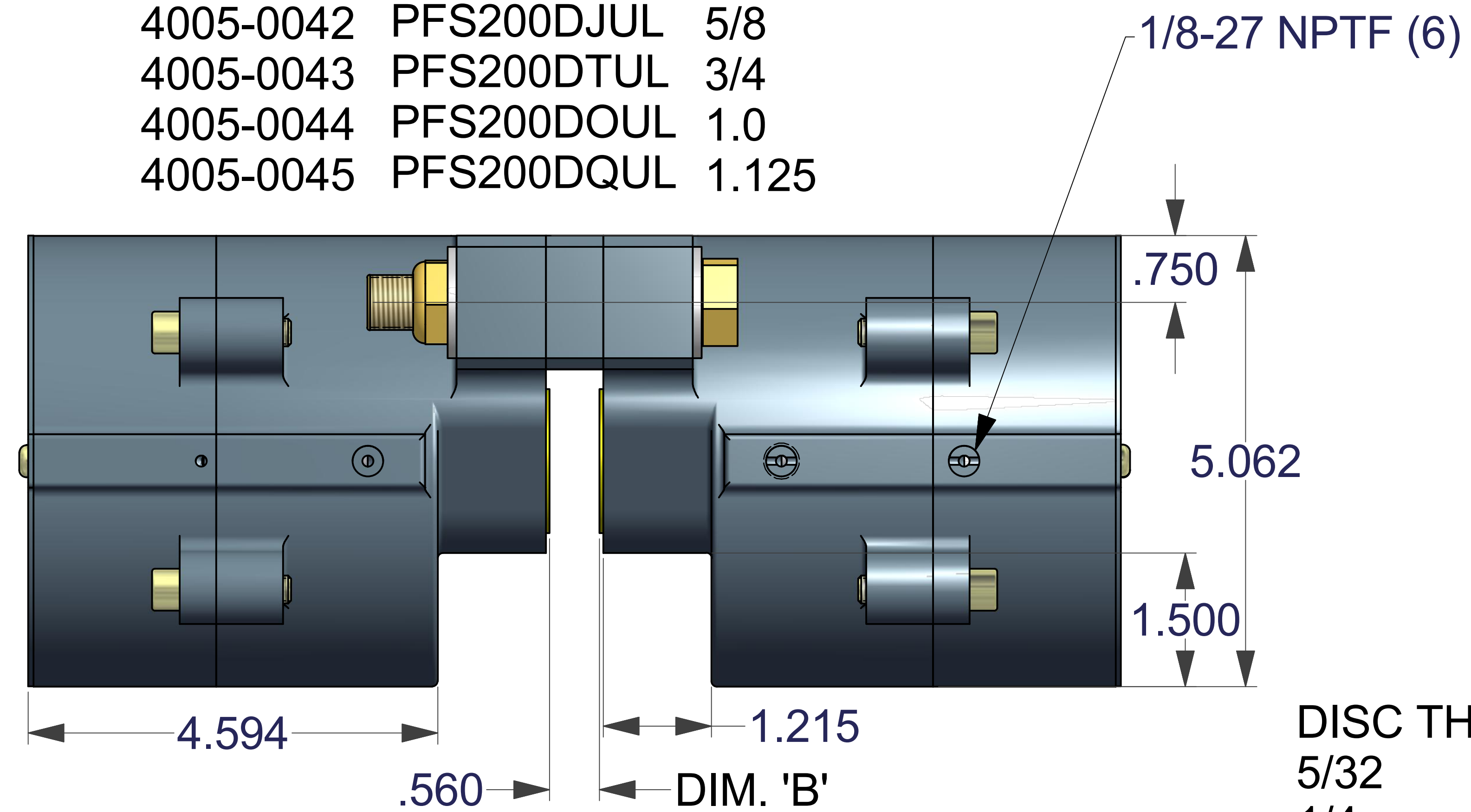
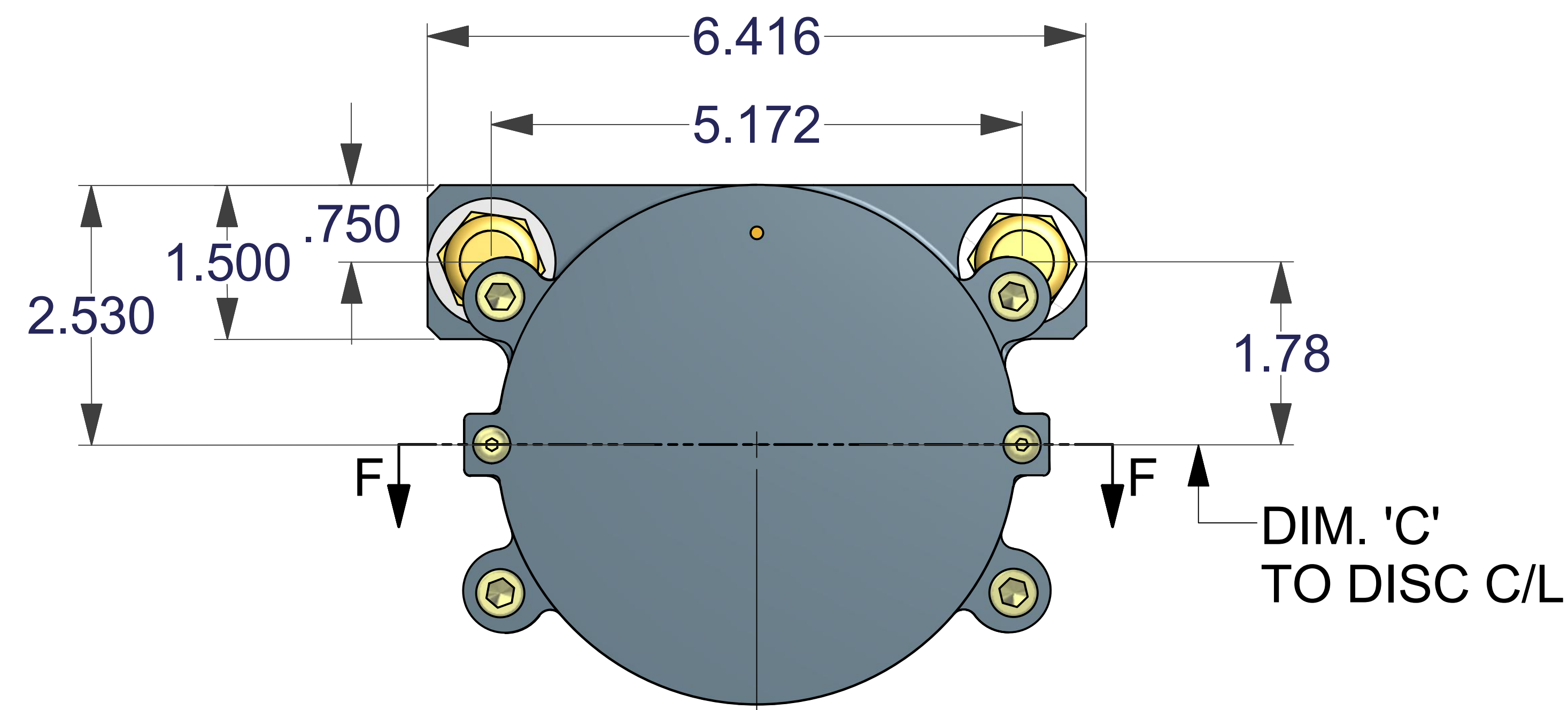

DISC DIA.	BRAKING RADIUS	DIM. 'C'
8.0	3.133	2.989
10.0	4.133	4.025
12.0	5.133	5.046
16.0	7.133	7.071
18.0	8.133	8.079
20.0	9.133	9.085
30.0	14.133	14.102

- * 85 PSI RELEASE PRESSURE
- * CAST ALUM. CONSTRUCTION
- * HARDCOATED HOUSINGS
- * 8.19 SQ. INCHES TOTAL FRICTION PAD AREA
- * UNLIMITED DISC DIAMETERS
- * REPLACEABLE FRICTION PADS
- * 2,065 LBS. OF CLAMPING FORCE
- * .45 COFF. OF FRICTION
- * DUEL BELLEVILLE DISC SPRING STACKS
- * NON-ASBESTOS FRICTION MATERIAL
- * BUNA N SEALS. VITON OPTIONAL
- * 1.82 CUBIC INCHES WEARABLE VOLUME

DISC THK.	DIM. 'A'	DIM. 'B'
5/32	.298	.216
1/4	.392	.310
3/8	.517	.435
1/2	.642	.560
5/8	.767	.685
3/4	.892	.810
1.0	1.142	1.06
1.125	1.267	1.185

UNLESS OTHERWISE SPECIFIED: DO NOT SCALE DRAWING REMOVE ALL BURRS TAP DEPTHS FULL THD. DRILL DEPTHS FULL DIA.	THIRD ANGLE PROJECTION	W.C. BRANHAM INC. RIVER FALLS, WI.
TOLERANCES 2 PLACE +/- .010 3 PLACE +/- .005	DESIGNER WCB 05/29/10	TITLE PFS200D UL SERIES
THREADS EXTERNAL CLASS 2A INTERNAL CLASS 2B	CHECKER DATE	DRAWING NO.
SCALE	CLASS	REVISION

SIZE
E