

INPUT TORQUE = OUTPUT TORQUE / .6

RPM	OUTPUT TORQUE, INCH LBS.
33	177
50	154
100	122
200	98
300	85
400	60
500	55
1,000	44
1,200	42

MAX. HAND TORQUE-- 302 IN. LBS.

KEY SIZE - 1.0 BORE - 1/4

- * PREFILLED WITH MAGNALUBE G GRADE 2 OR FOOD GRADE ACCROLUBE FG GRADE 2. PLEASE SPECIFY
- * 8620 HEAT TREATED 15 TOOTH GEARS
- * (4) STAINLESS R16 DBL. SEALED BALL BEARINGS
- * 304 STAINLESS HOUSING, CAPS, SHAFTS, KEYS, AND FASTENERS

NOTE: 'AAS' = ADD-A-SHAFT SERIES

4304-0796 15T AAS STAINLESS 1:1 RATIO R.H. A-BORE 1.0 B-BORE 1.0
 4304-0797 15T AAS STAINLESS 1:1 RATIO L.H. A-BORE 1.0 B-BORE 1.0

SEE 4304-0790 THRU 4304-0795 FOR OTHER BORE COMBINATIONS

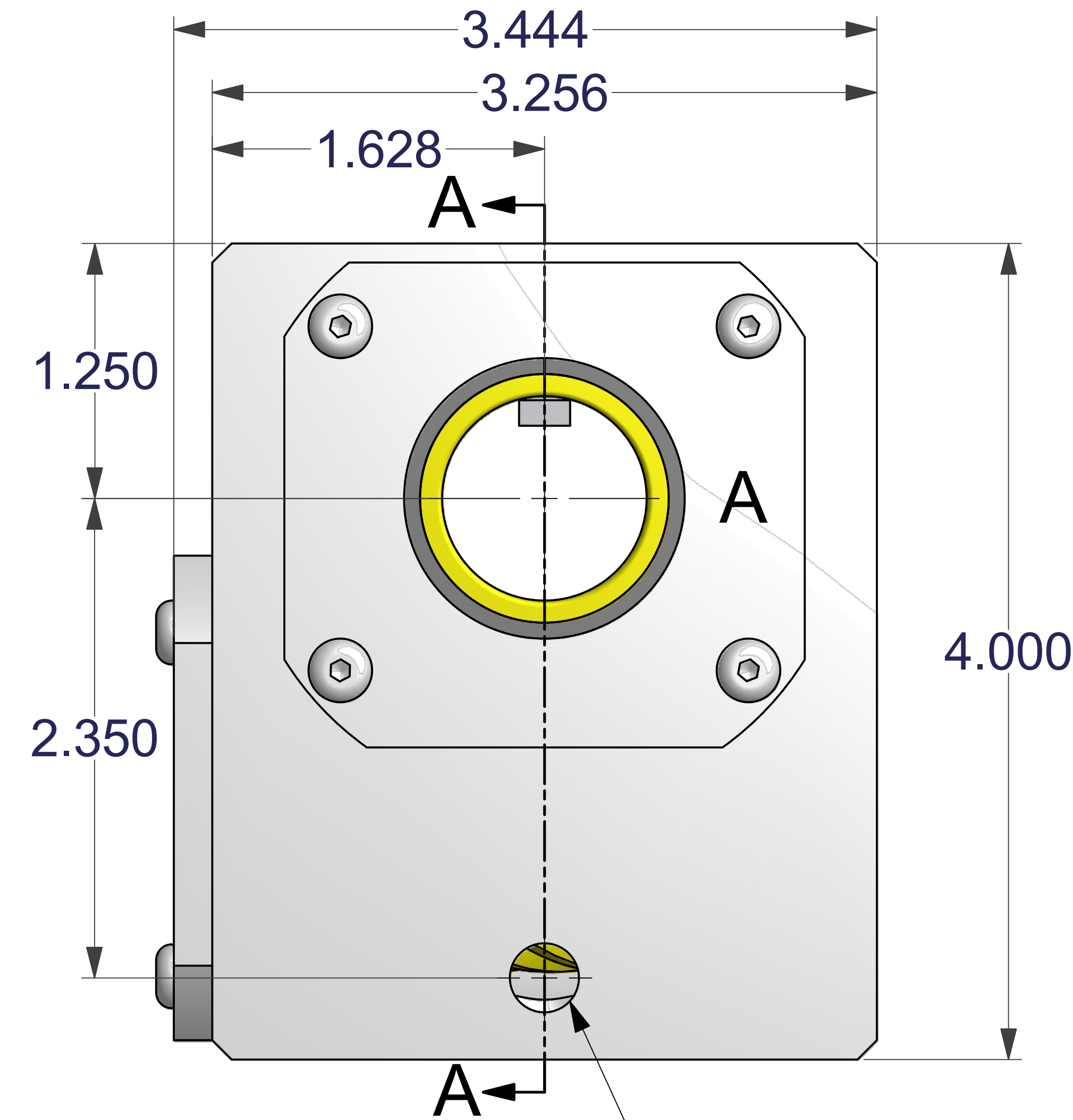
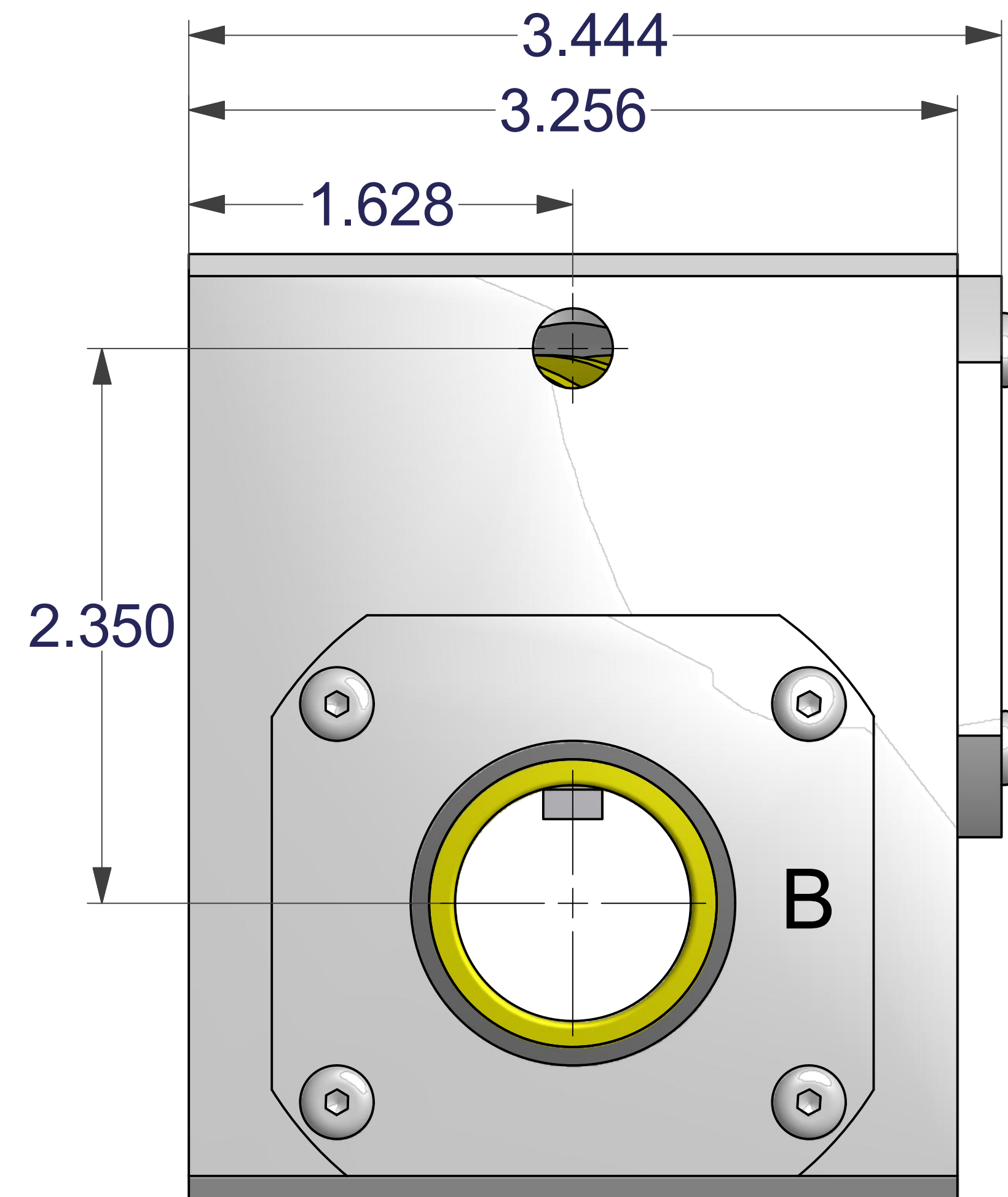
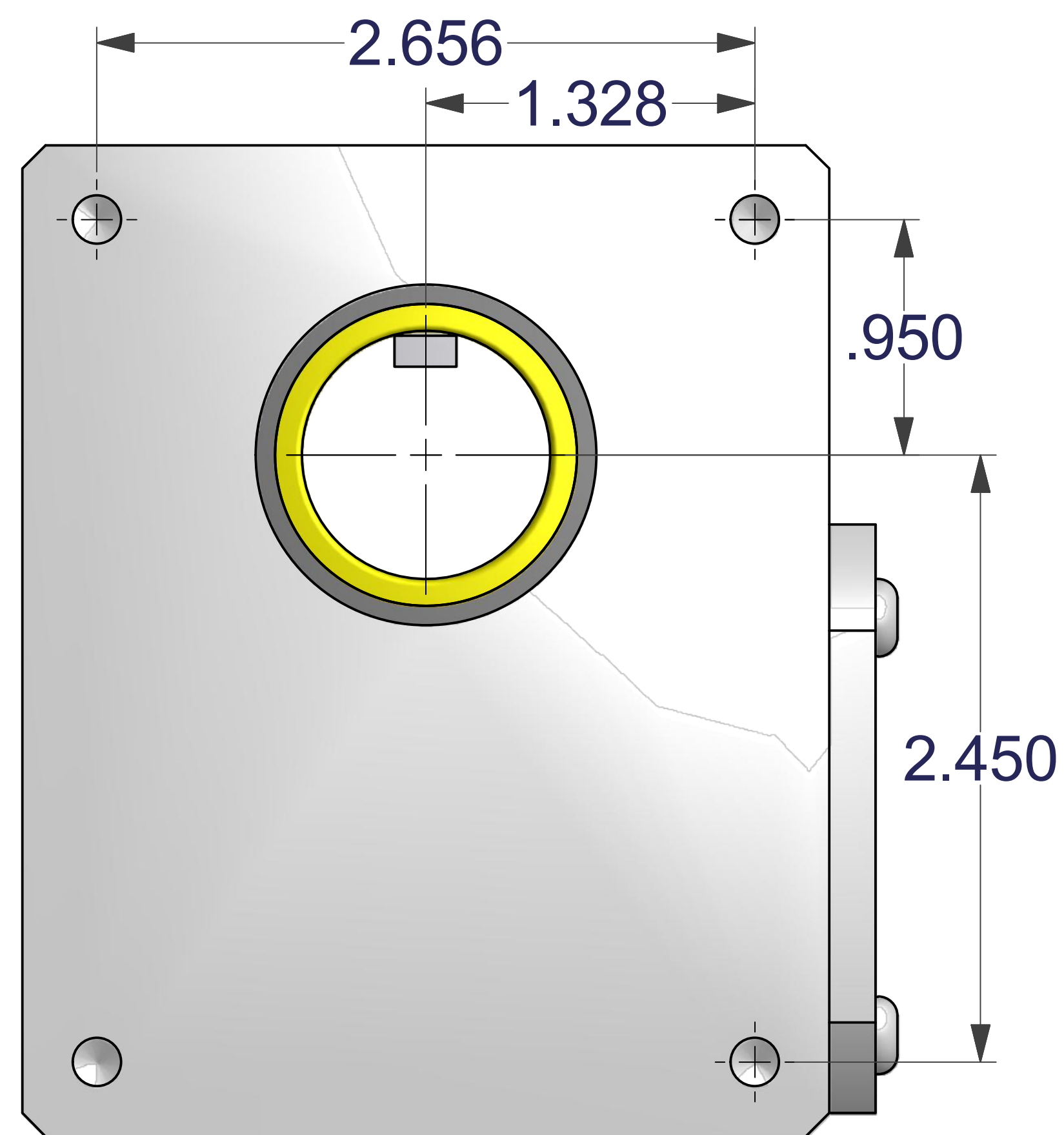

SECTION A-A
SCALE 2

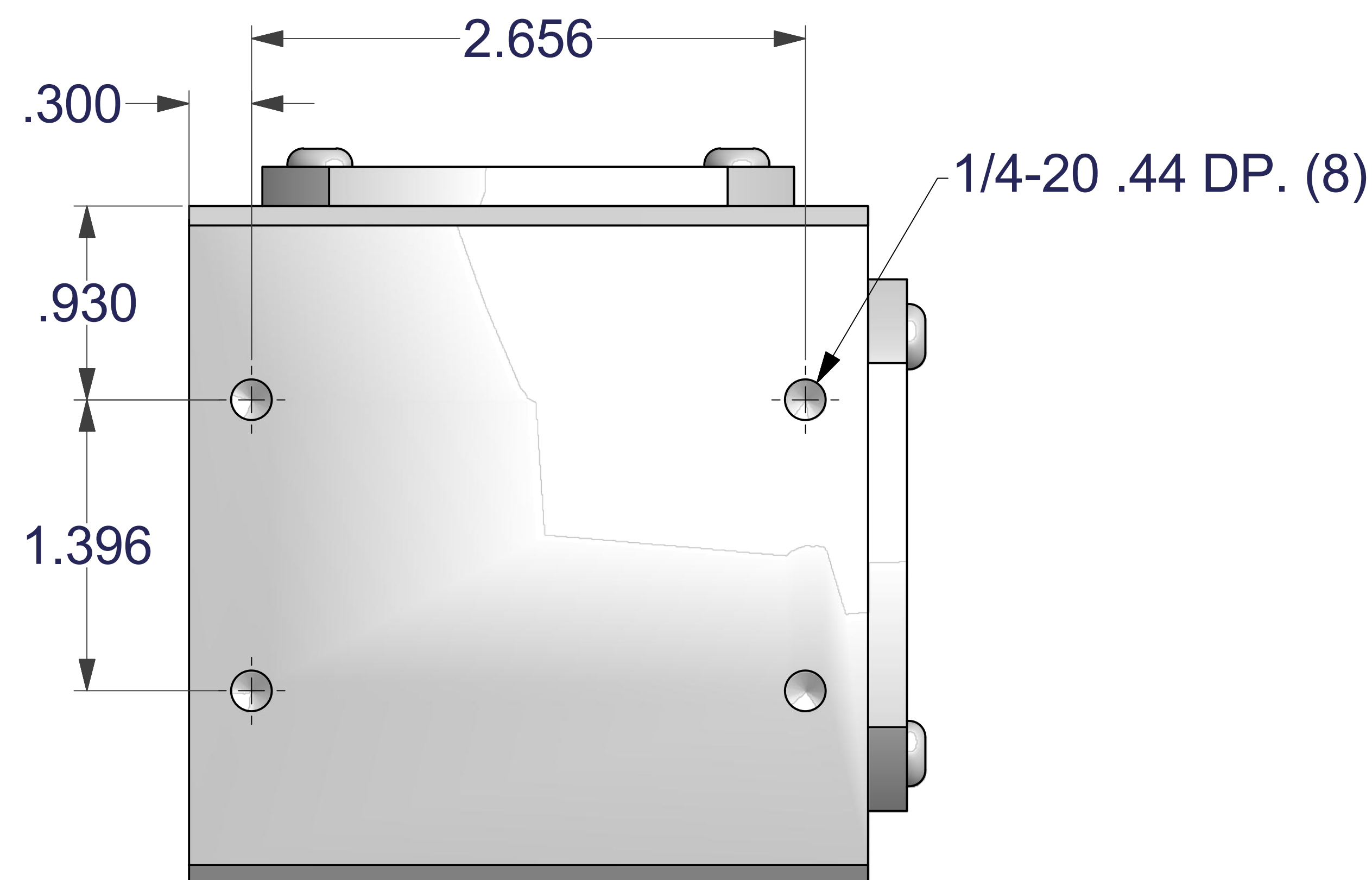
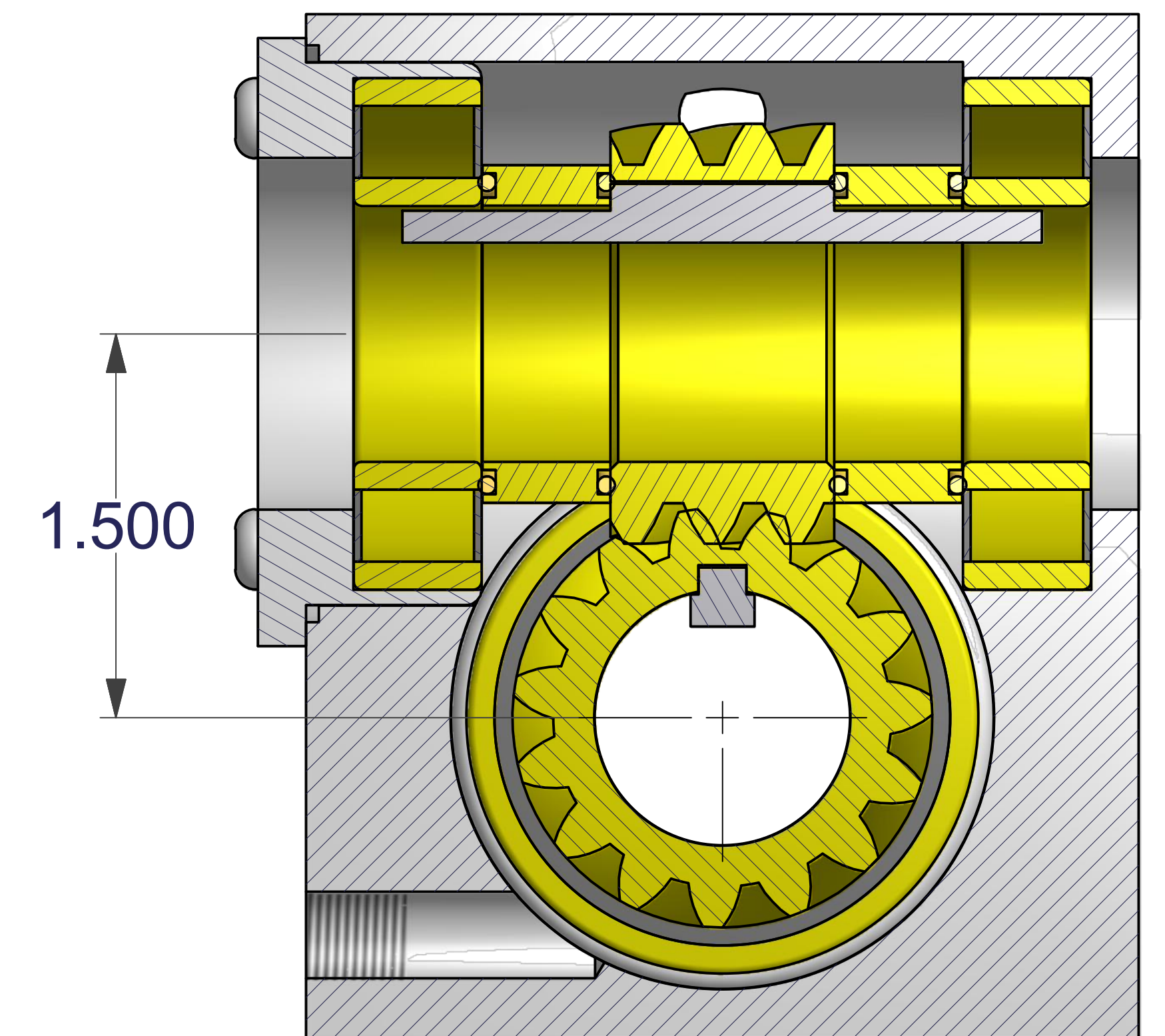

1/8-27 NPTF BREATHER/FILL PORT (2)

UNLESS OTHERWISE SPECIFIED: DO NOT SCALE DRAWING REMOVE ALL BURRS TAP DEPTHS FULL THD. DRILL DEPTHS FULL DIA.	THIRD ANGLE PROJECTION	WC BRANHAM INC. RIVER FALLS, WI	
	TOLERANCES 2 PLACE +/- .010 3 PLACE +/- .005		TITLE 15T STAINLESS AAS SERIES
	DESIGNER WCB 07/19/10	DATE 07/19/10	DRAWING NO.
	CHECKER	DATE	REVISION E