

INPUT TORQUE = OUTPUT TORQUE / .6  
 MAX. HAND TORQUE = 132 IN. LBS.

RPM	TORQUE, IN. LBS.
33	59
50	51
100	41
150	36
200	32
300	28
400	21
500	19
600	18
1,000	15
1,200	14
1,800	12

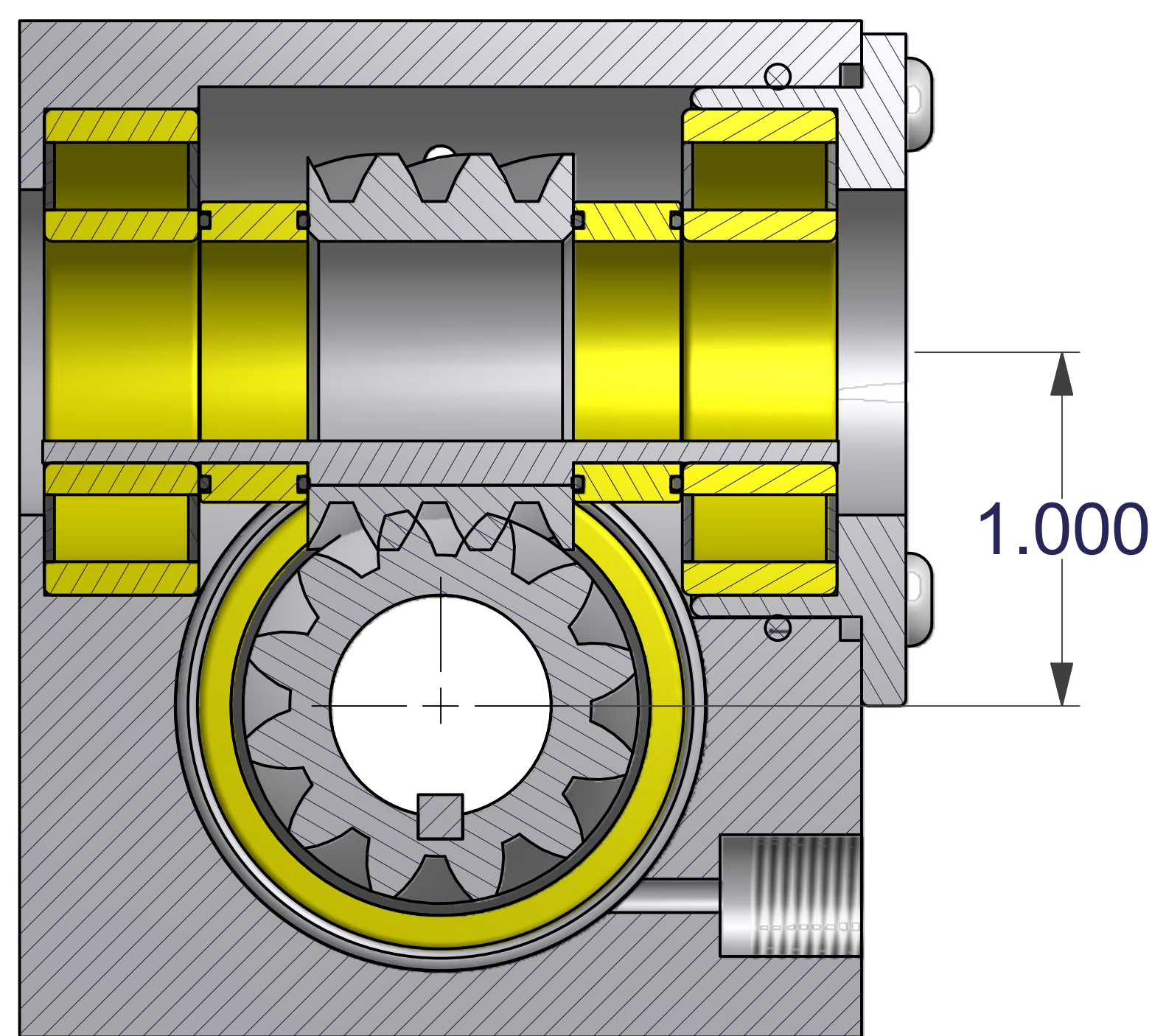

SECTION A-A  
SCALE 2.5

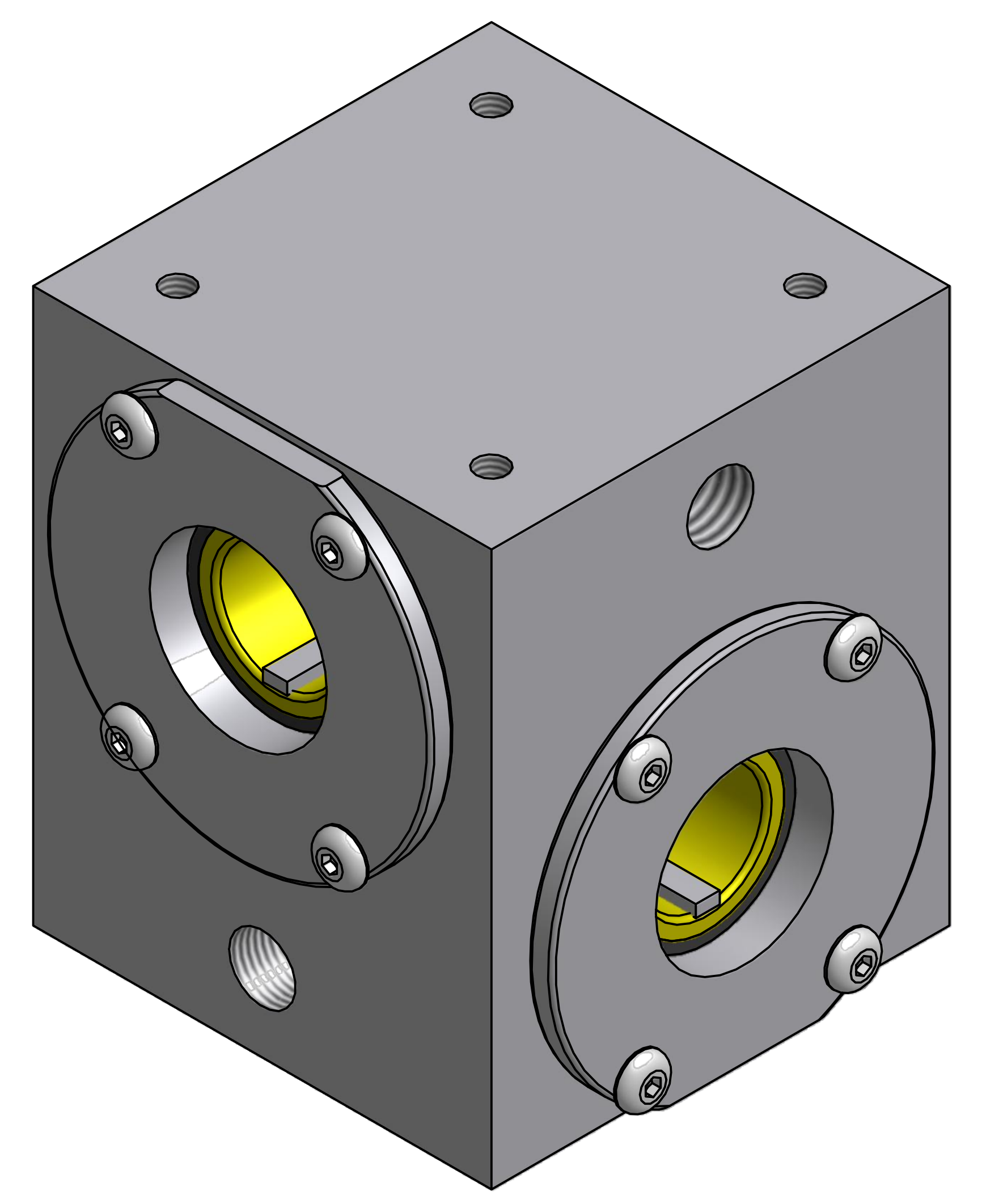
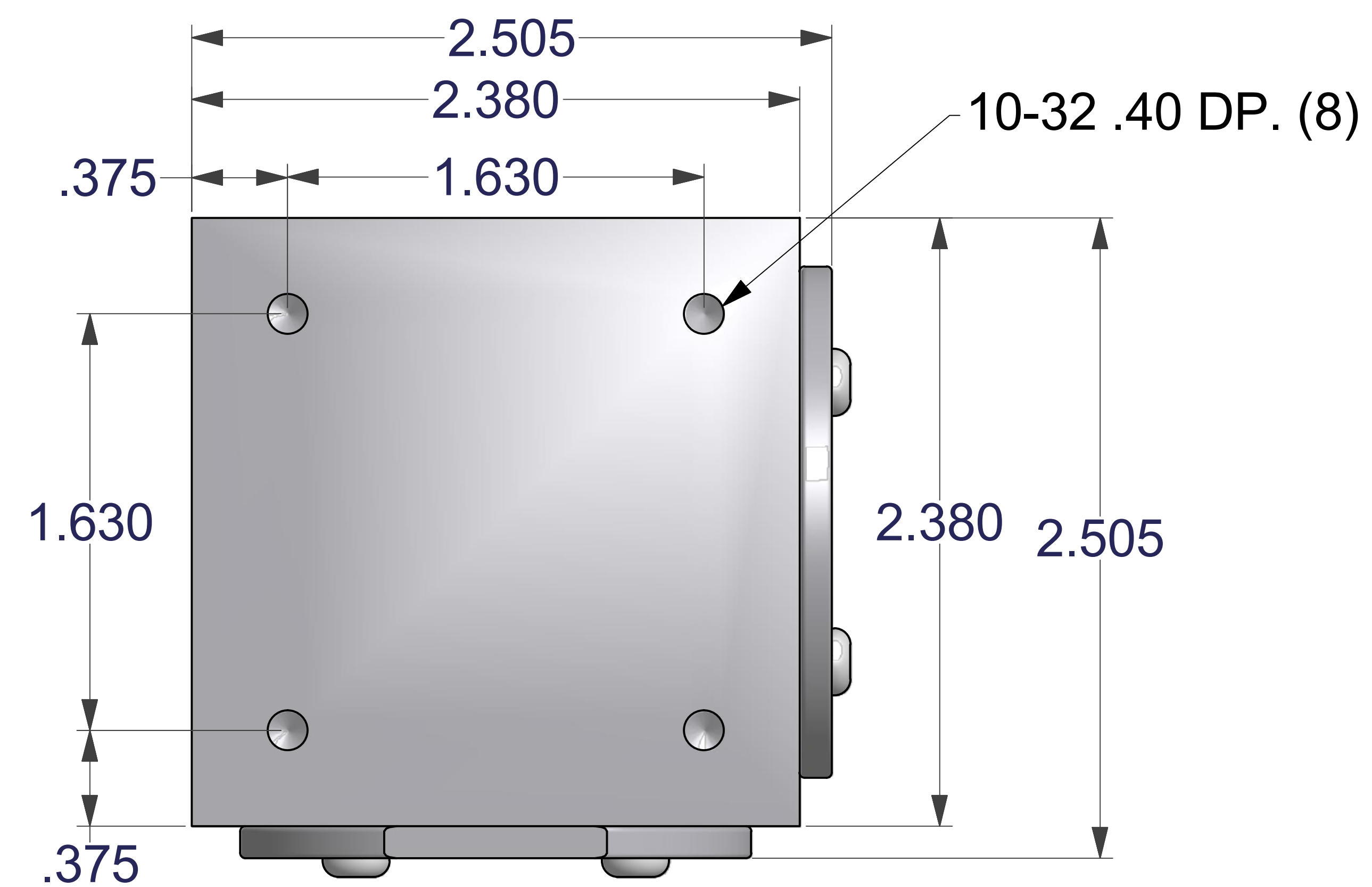
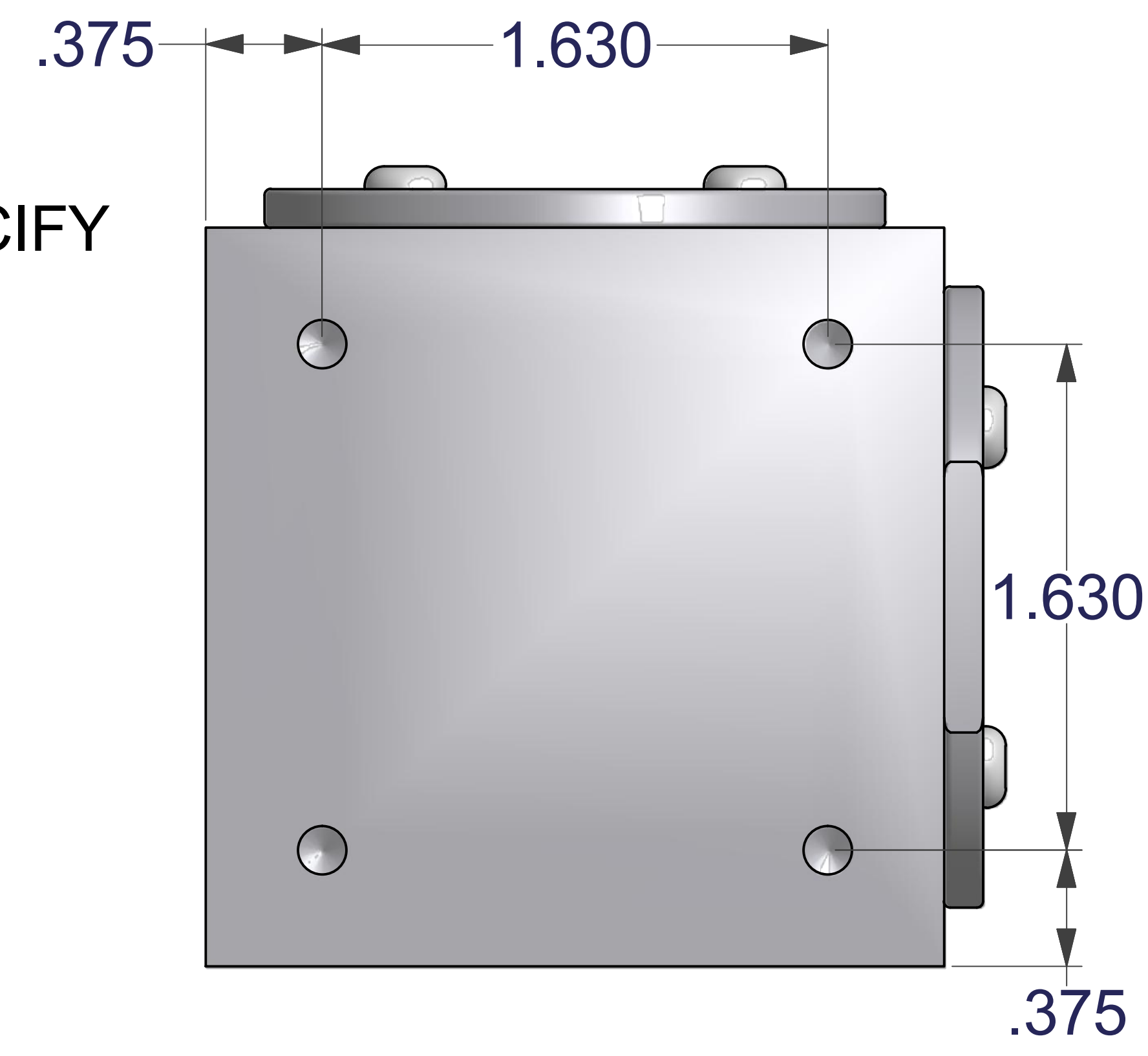
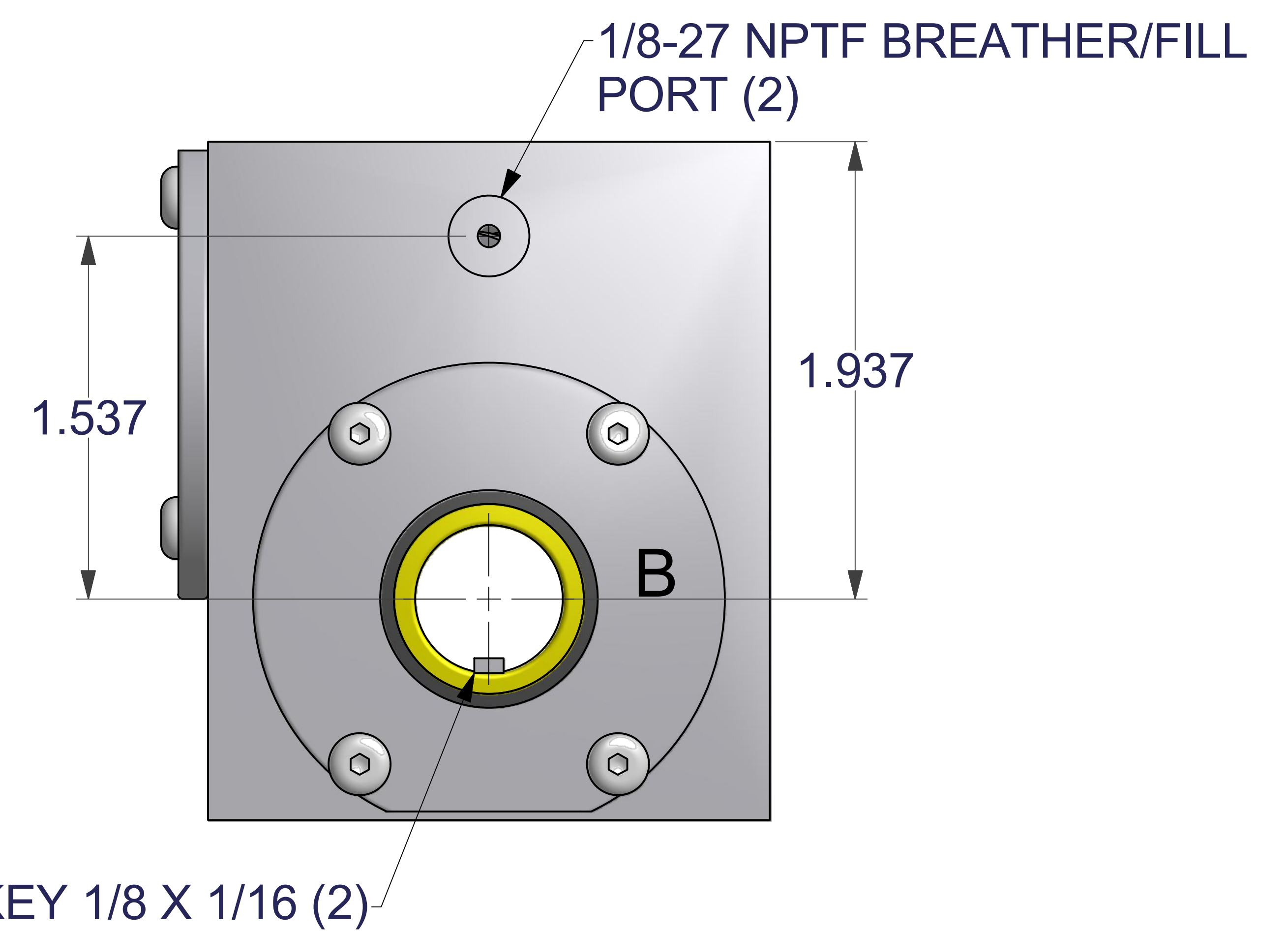
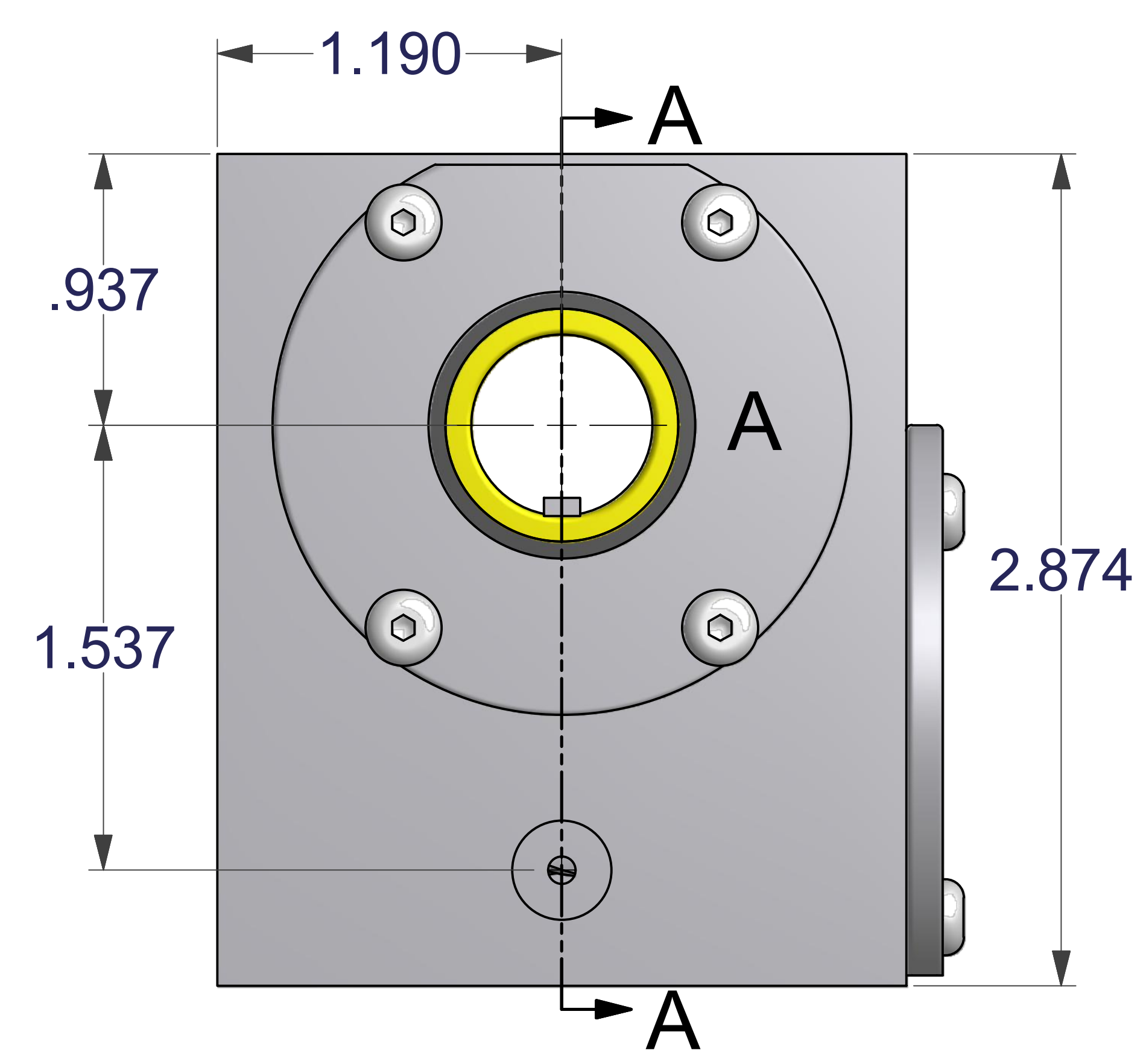

- \* PREFILLED WITH MAGNALUBE G GRADE 2 OR FOOD GRADE ACCROLUBE FG GRADE 2. PLEASE SPECIFY
- \* 8620 HEAT TREATED GEARS
- \* (4) STAINLESS R16 DBL. SEALED BALL BEARINGS
- \* 304 STAINLESS HOUSING, CAPS, KEYS & FASTENERS

PART NUMBER	TYPE	RATIO	ROTATION	A-BORE	B-BORE
4304-0146	AAS ALL	1:1 ALL	R.H.	5/8	5/8
4304-0186			L.H.	5/8	5/8
4304-0184			R.H.	1/2	5/8
4304-0185			L.H.	1/2	5/8
4304-0182			R.H.	1/2	1/2
4304-0183			L.H.	1/2	1/2

UNLESS OTHERWISE SPECIFIED: DO NOT SCALE DRAWING REMOVE ALL BURRS TAP DEPTHS FULL THD. DRILL DEPTHS FULL DIA.		THIRD ANGLE PROJECTION		WC BRANHAM INC. RIVER FALLS, WI	
TOLERANCES 2 PLACE +/- .010 3 PLACE +/- .005	DESIGNER WCB	DATE 07/21/10	CHECKER	TITLE MINI STAINLESS DIMENSIONAL	REVISION
THREADS EXTERNAL CLASS 2A INTERNAL CLASS 2B	SCALE	CLASS	DRAWING NO.		

SIZE  
**E**