

INPUT TORQUE = OUTPUT TORQUE / .6

RPM	OUTPUT TORQUE, INCH LBS.	MAX. HAND TORQUE -- 302 IN. LBS.
33	177	
50	154	
100	122	KEY SIZES
200	98	5/8 BORE - 3/16
300	85	3/4 BORE - 3/16
400	60	
500	55	
1,000	44	
1,200	42	

- * PREFILLED WITH LUBRIPLATE 1500 GRADE 00 OR FOOD GRADE ACCROLUBE FG GRADE 2. PLEASE SPECIFY
- * 8620 HEAT TREATED 15 TOOTH GEARS
- * (4) STAINLESS R16 DBL. SEALED BALL BEARINGS
- * 304 STAINLESS HOUSING, CAPS, SHAFTS, KEYS, AND FASTENERS
- * (4) SPRING LOADED SHAFT SEALS

NOTE: 'IAS' = INSERT-A-SHAFT SERIES

PART NUMBER	RATIO	TYPE	ROTATION	A-BORE	B-BORE
4304-0790	1:1 ALL	IAS ALL	R.H.	5/8	5/8
4304-0791			L.H.	5/8	5/8
4304-0792			R.H.	3/4	5/8
4304-0793			L.H.	3/4	5/8
4304-0794			R.H.	3/4	3/4
4304-0795			L.H.	3/4	3/4

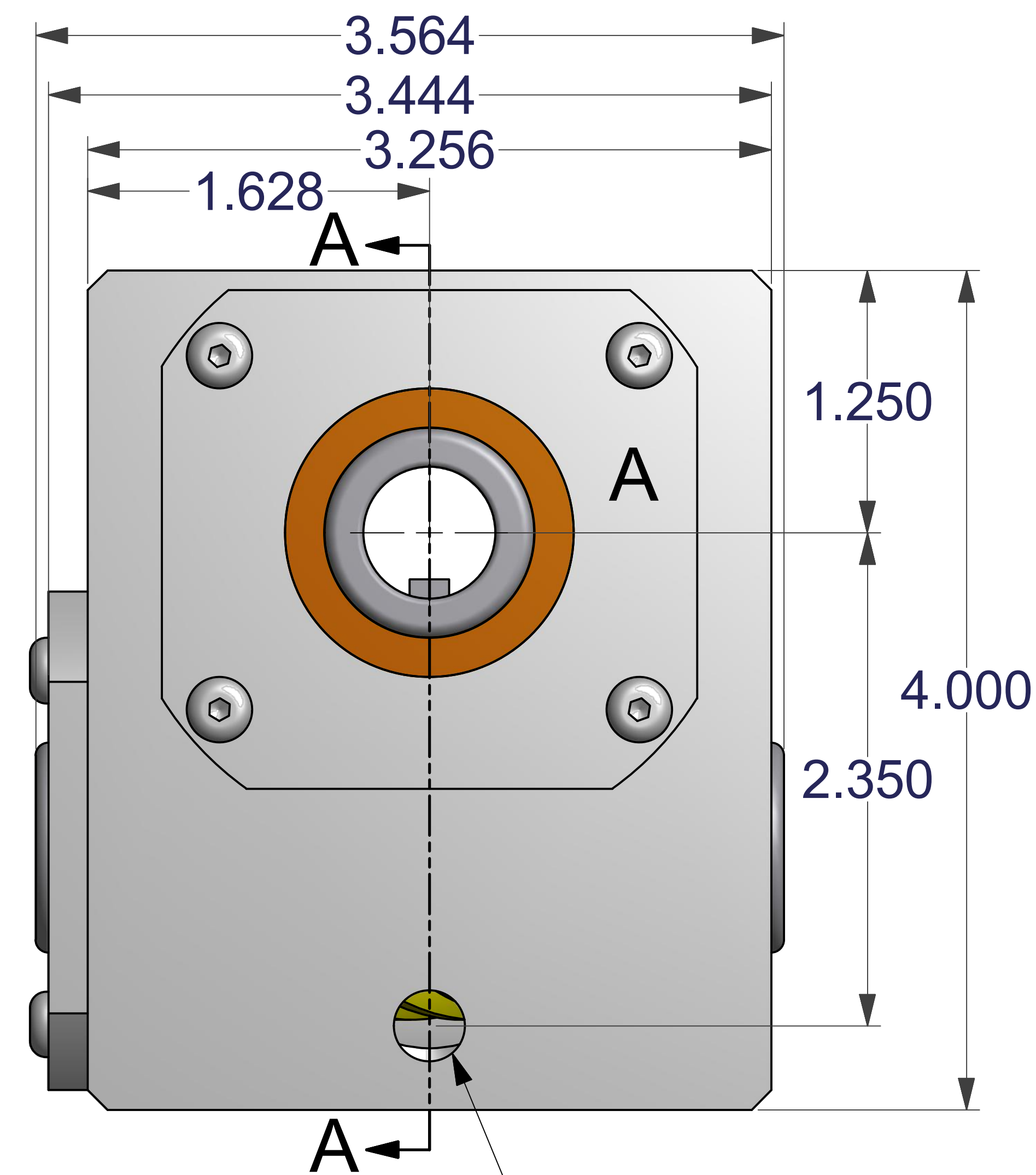
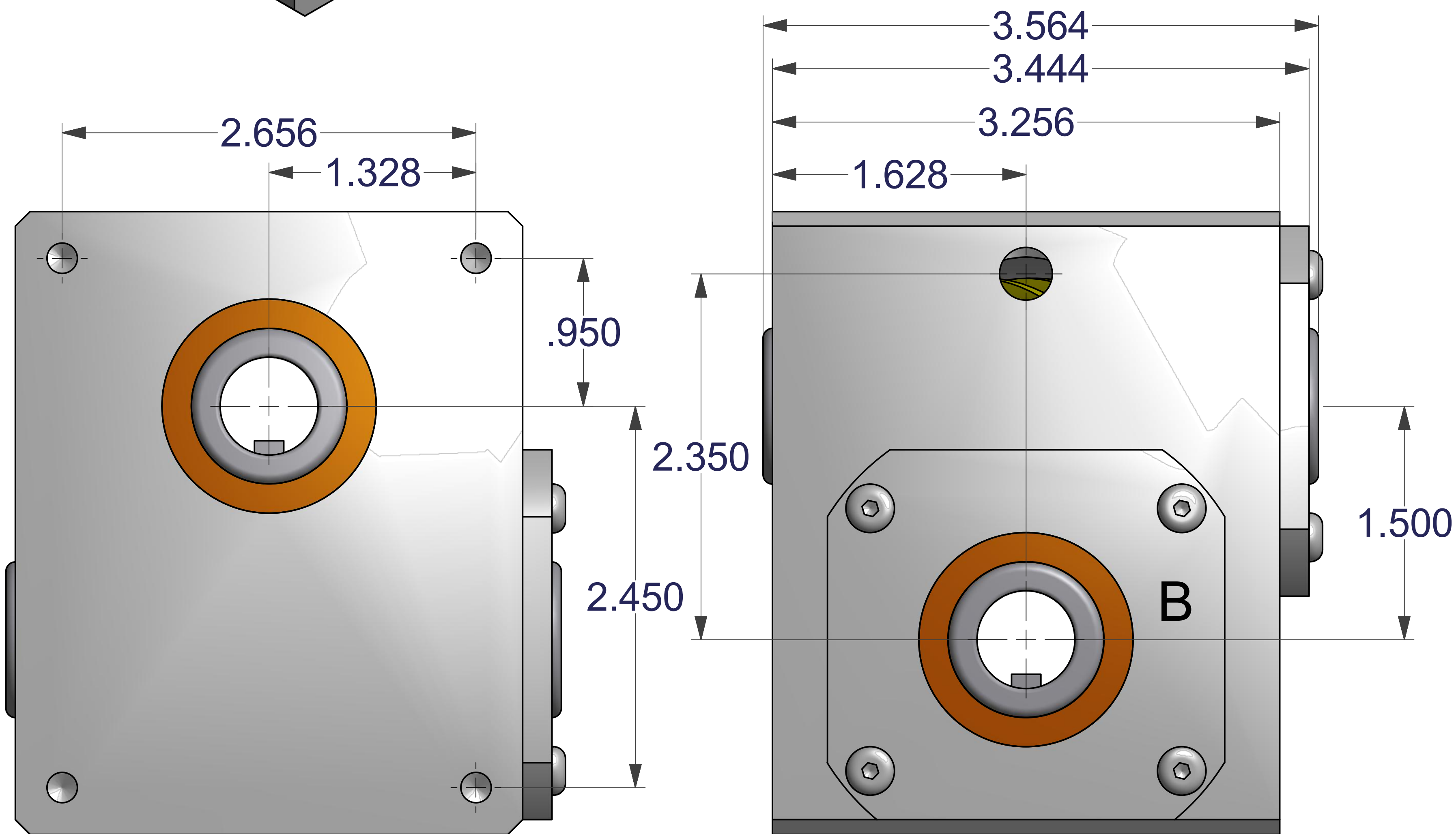

SECTION A-A
SCALE 2

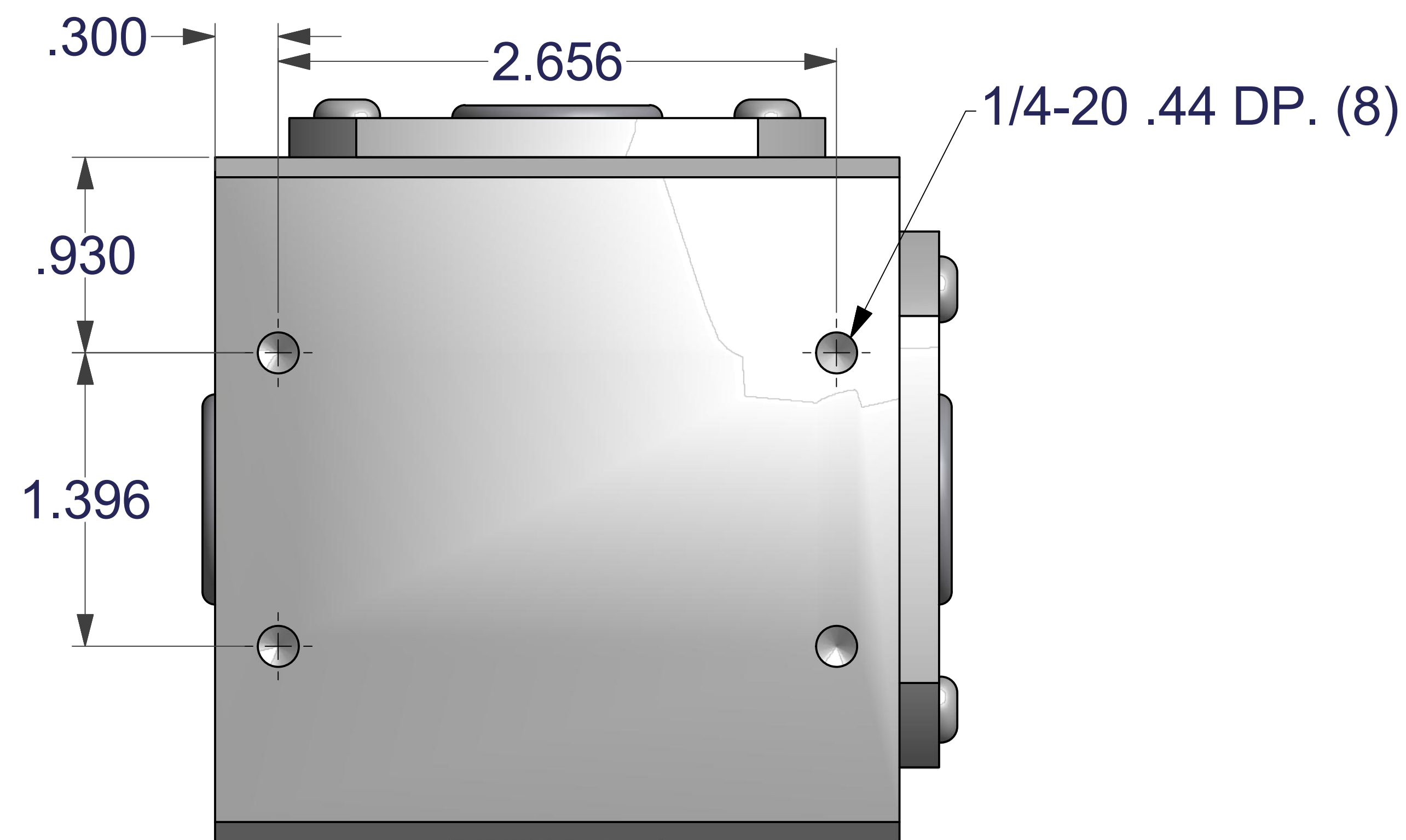
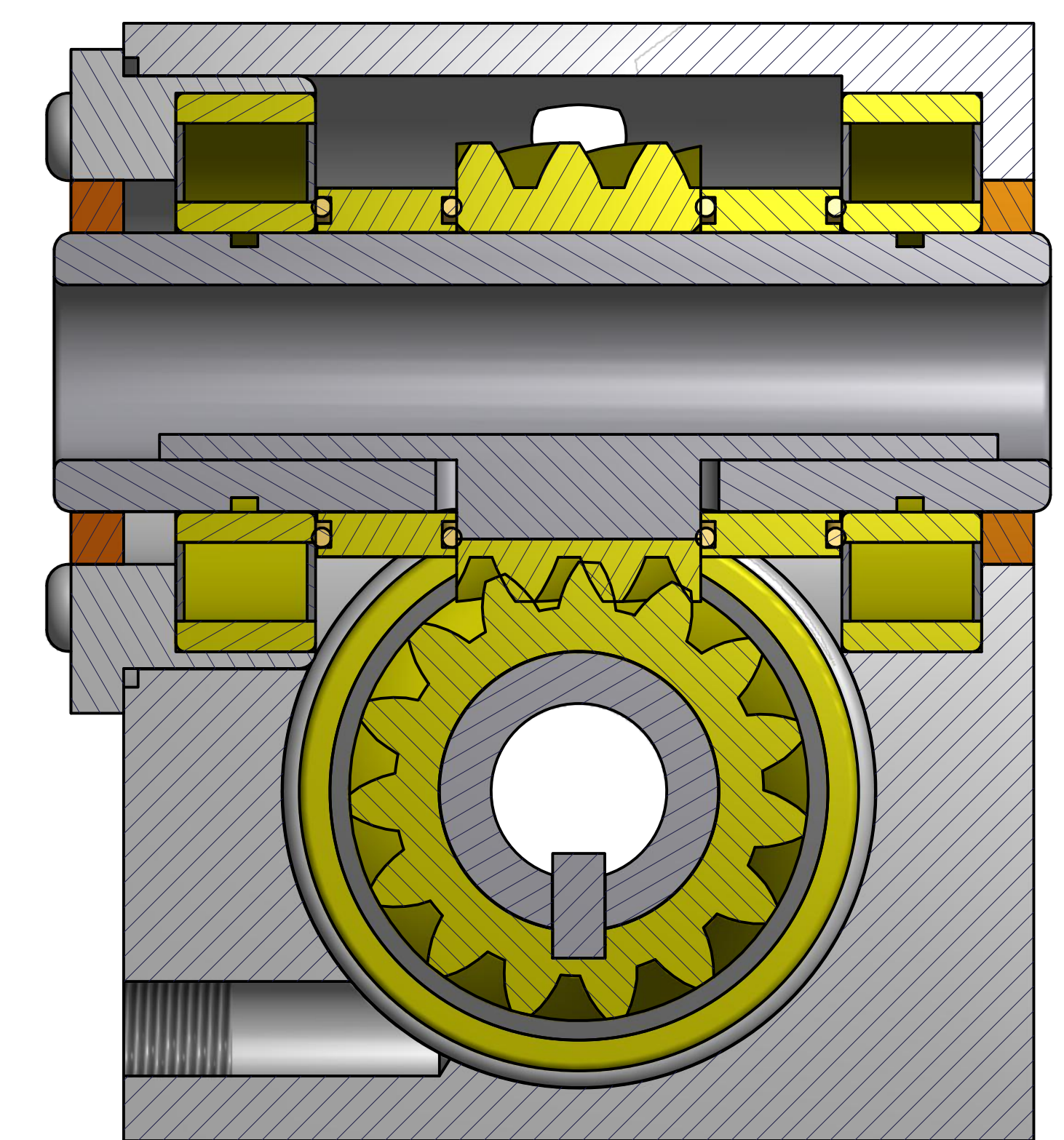

1/8-27 NPTF BREATHER/FILL PORT (2)

<small>UNLESS OTHERWISE SPECIFIED: DO NOT SCALE DRAWING REMOVE ALL BURRS TAP DEPTHS FULL THD. DRILL DEPTHS FULL DIA.</small>	<small>THIRD ANGLE PROJECTION</small> 	WC BRANHAM INC. RIVER FALLS, WI	
	<small>TOLERANCES</small> 2 PLACE +/- .010 3 PLACE +/- .005	<small>DESIGNER</small> WCB	<small>DATE</small> 07/19/10
	<small>THREADS</small> EXTERNAL CLASS 2A INTERNAL CLASS 2B	<small>CHECKER</small> WCB	<small>DATE</small>
	<small>SCALE</small> 	<small>DRAWING NO.</small> 	<small>REVISION</small>

SIZE
E